



## Acacia Top Kitchen Cart with Drawers

Model #: FRN04748B

### Customer Service Information

**Seville Classics, Inc.**

Telephone: (800) 323-5565

Fax: (310) 533-3899

Hours: 8:30 AM – 4:30 PM (PST)

Email: [Support@SevilleClassics.com](mailto:Support@SevilleClassics.com)

Online Store: [www.SevilleClassics.com](http://www.SevilleClassics.com)



Use the camera on your smartphone to scan  
the QR code to watch assembly video.

Please review the below parts list to ensure you received all the necessary parts.  
 If you are missing any parts or have trouble with assembly,  
 please contact our live customer support team at **(800) 323-5565** or  
**[Support@sevilleclassics.com](mailto:Support@sevilleclassics.com)**, which can assist you in both English and Spanish.



We recommend two people to assemble the cart.



## Parts List

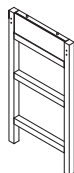

A. Right side frame (1 pc)

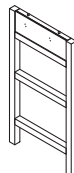

B. Left side frame (1 pc)

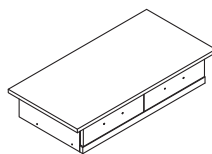

C. Acacia top (1 pc)

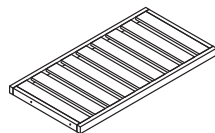

D. Shelf (2 pcs)



E. Towel bar bracket (2 pcs)



F. Large bolt 1/4 x 35 (14 pcs)



G. Medium bolt 3/16 x 35 (4 pcs)



H. Screw M3 x 12 (4 pcs)



I. Small bolt M4 x 22 (4 pcs)



J. Handle (2 pcs)



K. Hook (2 pcs)



L. Locking wheel (2 pcs)



M. Wheel (2 pcs)



N. Allen wrench (1 pc)



O. Towel bar (1 pc)



P. Sticker (4 pcs)

**Other tools needed:** Phillips head screwdriver (not included)



## WARNING

- **Read all instructions and inspect parts prior to assembly.**
- Tighten wheels completely and check periodically.
- Lock the wheels when leaving cart in stationary position.
- Do NOT modify the product in any way.
- Do NOT overload the product.
- This cart is NOT a toy.
- Do NOT let children climb or play on the cart.
- Place heavier objects on the lowest shelf.
- Use caution when moving cart.
- Do NOT move while cart is loaded.

Please visit **[sevilleclassics.com](http://sevilleclassics.com)** to shop our wide range of products.

## WEIGHT CAPACITY:

**Acacia Top:** 36.3 kg / 80 lb

**Per Shelf:** 22.7 kg / 50 lb

**Per Drawer:** 4.5 kg / 10 lb

**Per Hook:** 2.3 kg / 5 lb

**Total capacity of kitchen cart:** 95.2 kg / 210 lb



## Note:

Please be considerate of the environment and recycle the brown box the item was delivered in along with all applicable packaging materials. Thank you.

## STEP 4

Use a Phillips head screwdriver to attach the **HANDLES (J)** to each drawer.

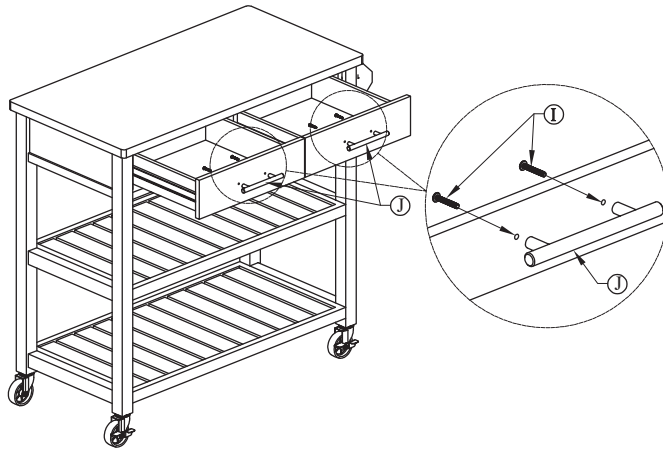

## STEP 5

Attach the **HOOKS (K)** to the cart using **SCREWS (H)** with a Phillips head screwdriver.

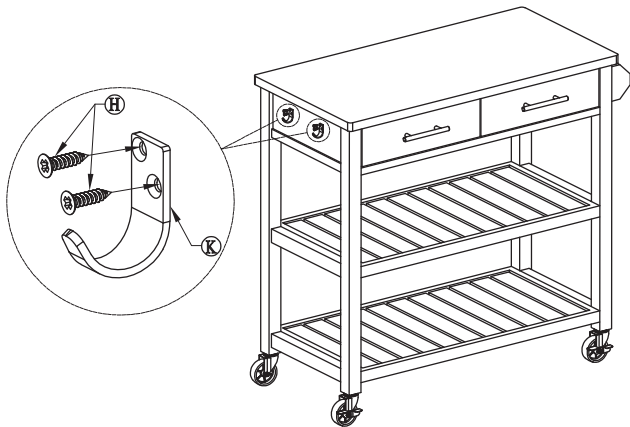

## CARE AND MAINTENANCE

**Avoid harsh, abrasive cleaners, and other corrosive chemicals.**  
**Clean up any spills immediately to prevent stains from forming**  
**on the wood top. Wood top can be cleaned with damp cloth**  
**and wiped dry immediately with dry cloth.**

## STEP 1

Insert **TOWEL BAR (O)** in to **BRACKETS (E)** and attach to **RIGHT SIDE FRAME (A)** using four **MEDIUM BOLTS (G)**.

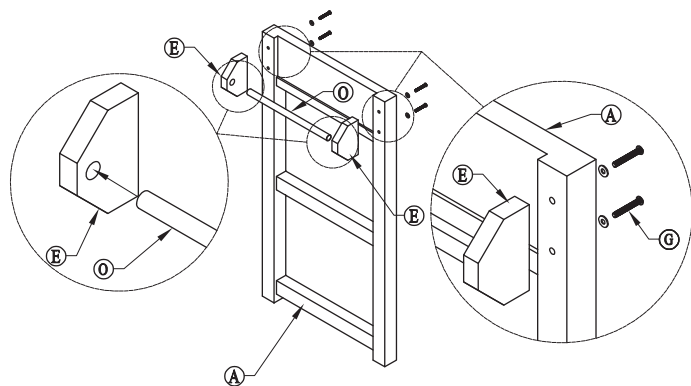

## ALTERNATIVE TO STEP 1

If you do not wish to install the towel bar, **STICKERS (P)** have been provided to conceal the holes where the towel bar is installed.

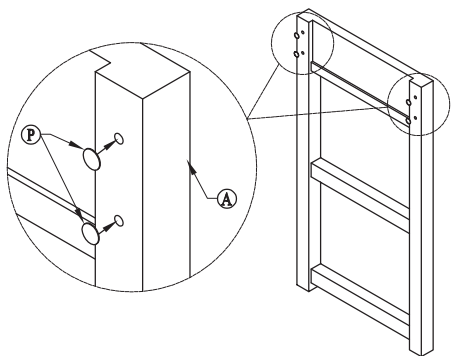

## STEP 2

Flip the table top upside down and extend the drawers. **Note: Extending the drawers out is necessary to install some bolts.** Line up **RIGHT and LEFT SIDE FRAMES (A and B)** with holes on the **ACACIA TOP (C)**. Use 6 x **LARGE BOLTS (F)** to secure both side frames. Then install both **SHELVES (D)** to the side frames using the 8 remaining **LARGE BOLTS (F)**. Do not fully tighten screws until the 2nd shelf is secured.

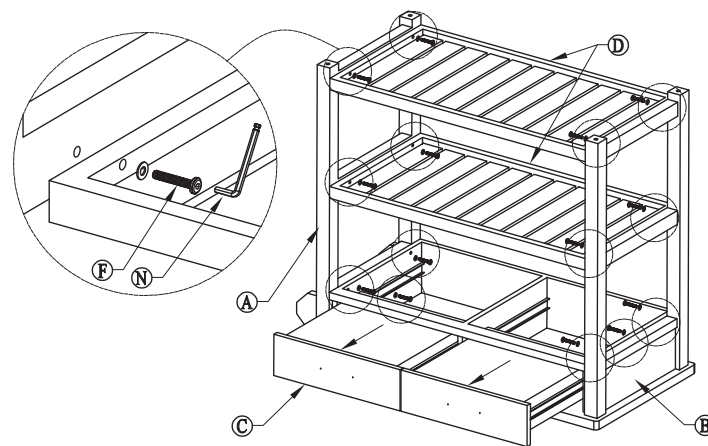

## STEP 3

Screw **LOCKING WHEEL (L)** into the front of **SIDE FRAMES (A and B)**. Screw **WHEELS (M)** into back of **SIDE FRAMES (A and B)**.

