



## ASSEMBLY INSTRUCTIONS

UltraHD Rolling Work Center (Model No. 20118)

73 in. W X 20 in. D X 37.5 in. H  
(185.4cm W x 50.8cm D x 95.2cm H)

**ULTRAGUARD®**

FINGERPRINT RESISTANT SURFACES  
AND INCREASED DURABILITY

Reference page 15 for special care and  
maintenance of stainless steel

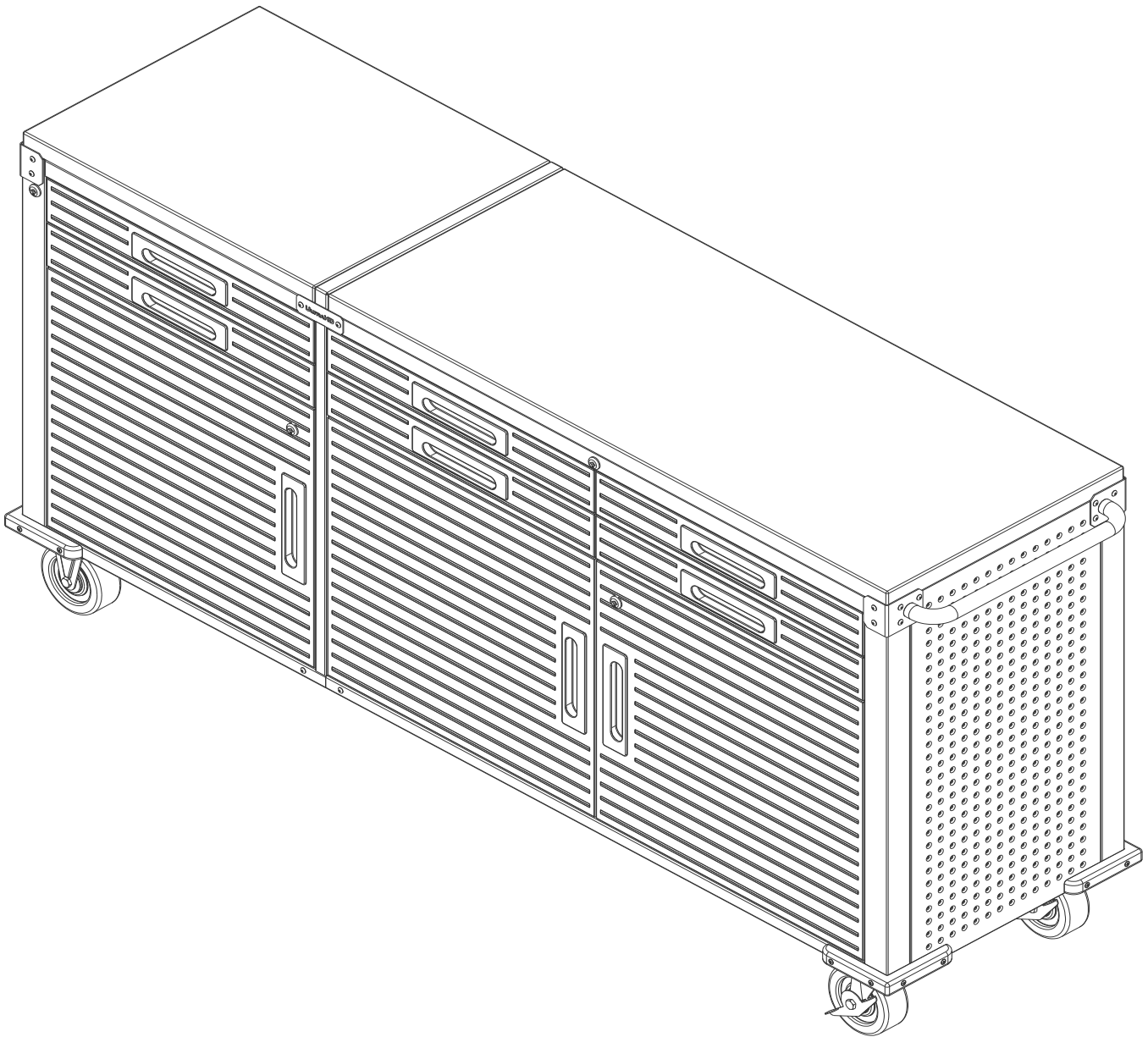

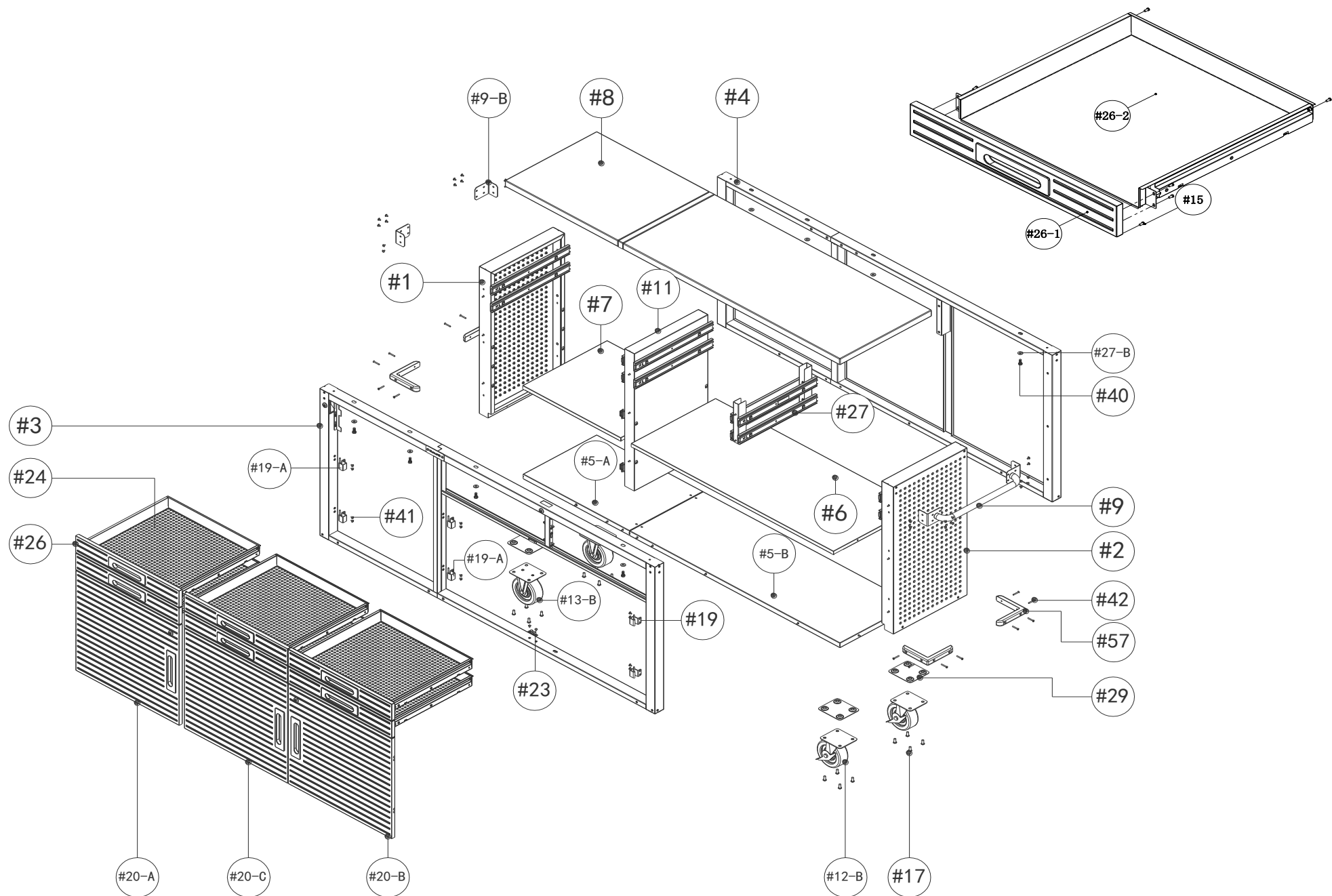

# PARTS LIST

Please check the parts carefully according to the parts list. If you are missing any parts, please contact our customer service department (please refer to page 16).

## (#3) FRONT FRAME x 1 PC

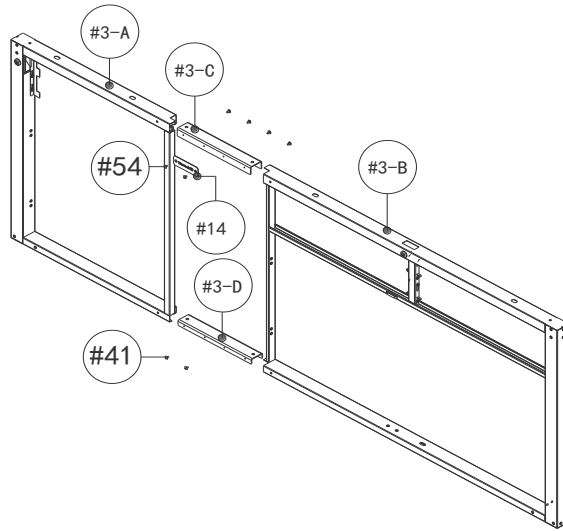

## (#4) BACK FRAME x 1 PC

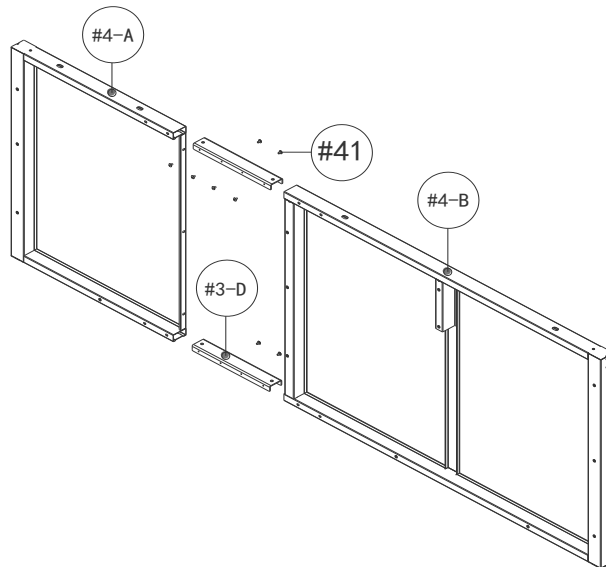

## (#8) SOLID HARDWOOD TOP x 1 PC

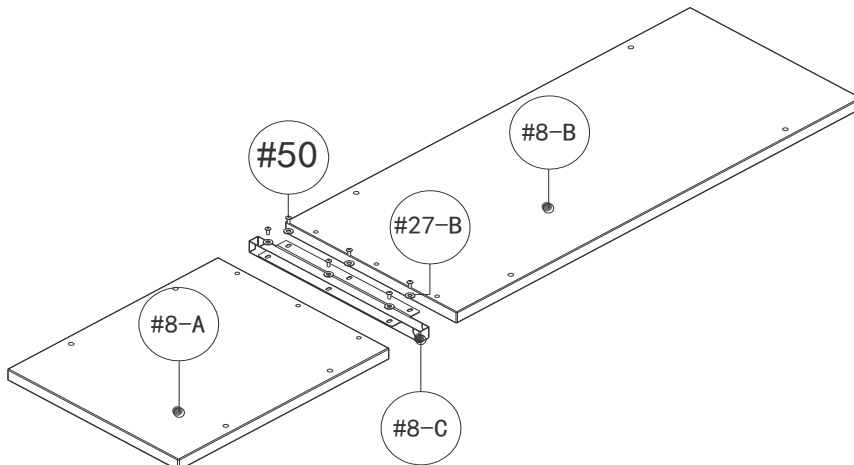

# PARTS LIST

Please check the parts carefully according to the parts list. If you are missing any parts, please contact our customer service department (please refer to page 16).

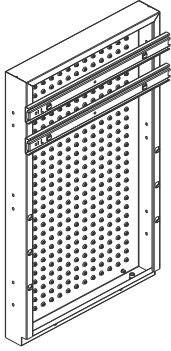

**(#1) LEFT SIDE PANEL x 1 PC**

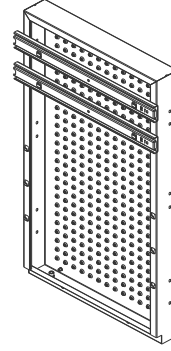

**(#2) RIGHT SIDE PANEL x 1 PC**

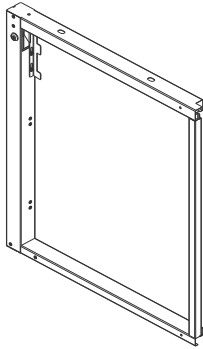

**(#3-A) LEFT FRONT FRAME x 1 PC**

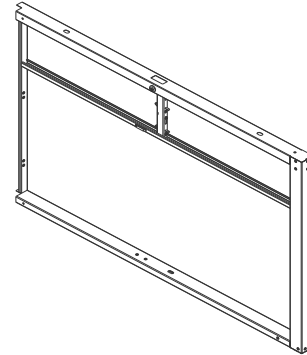

**(#3-B) RIGHT FRONT FRAME x 1 PC**

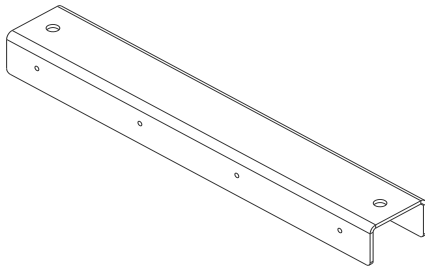

**(#3-C) UPPER CONNECTION BRACKET x 1 PC**

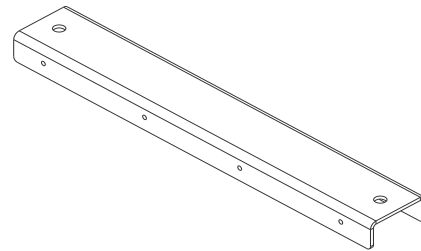

**(#3-D) CONNECTION BRACKET x 3 PCS**

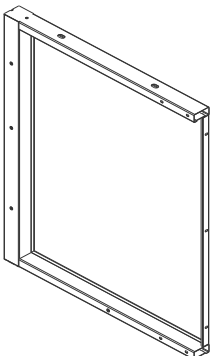

**(#4-A) LEFT BACK FRAME x 1 PC**

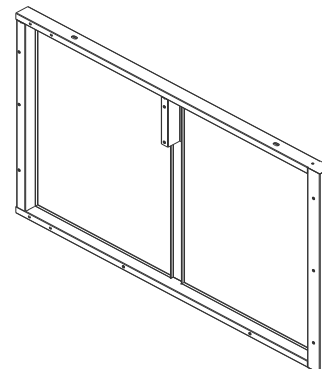

**(#4-B) RIGHT BACK FRAME x 1 PC**

# PARTS LIST

Please check the parts carefully according to the parts list. If you are missing any parts, please contact our customer service department (please refer to page 16).

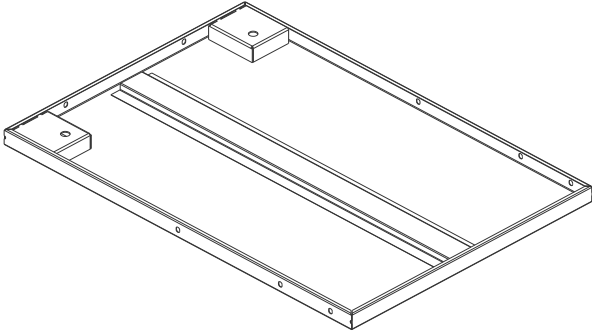

**(#5-A) LEFT BOTTOM PANEL x 1 PC**

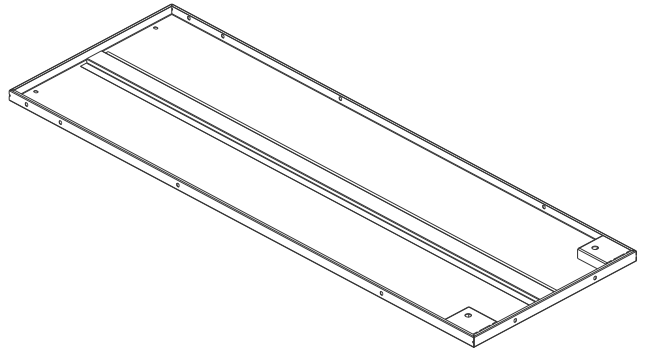

**(#5-B) RIGHT BOTTOM PANEL x 1 PC**

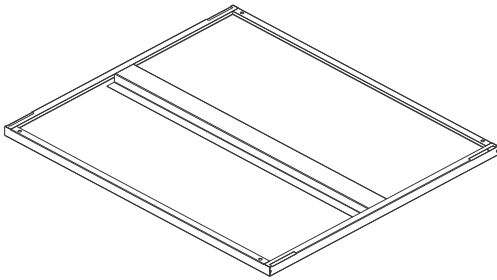

**(#7) LEFT MIDDLE SHELF x 1 PC**

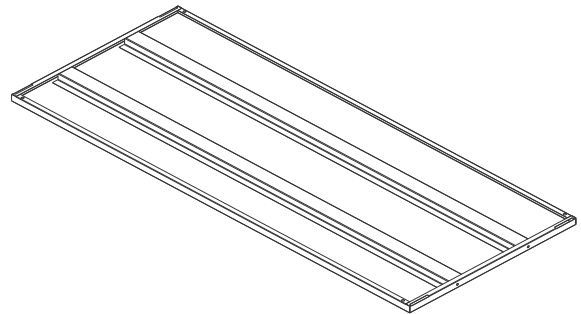

**(#6) SHELF x 1 PC**

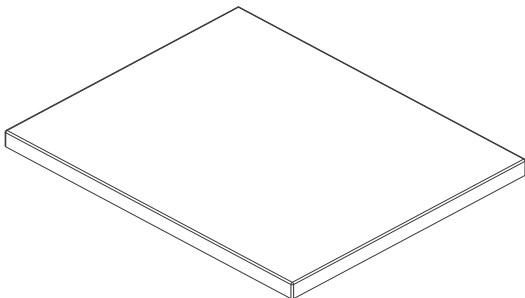

**(#8-A) LEFT WOOD TOP x 1 PC**

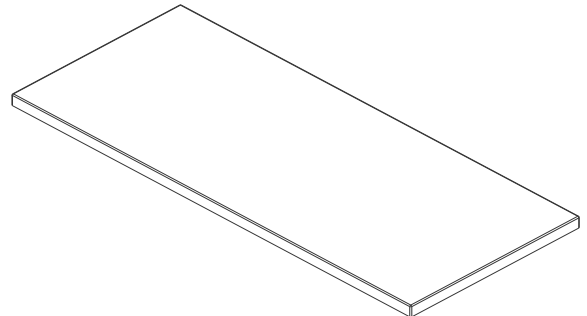

**(#8-B) RIGHT WOOD TOP x 1 PC**

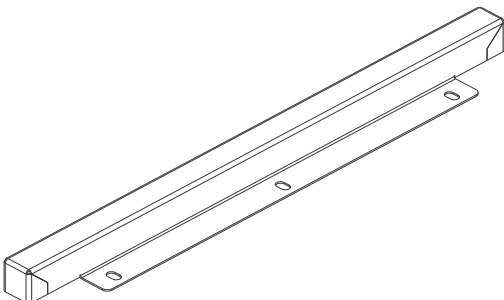

**(#8-C) WOOD TOP CONNECTION x 1 PC**

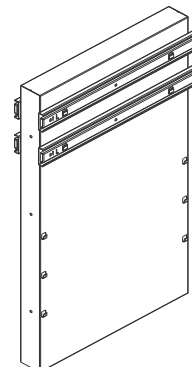

**(#11) LEFT SIDE SLIDER SUPPORT x 1 PC**

# PARTS LIST

Please check the parts carefully according to the parts list. If you are missing any parts, please contact our customer service department (please refer to page 16).

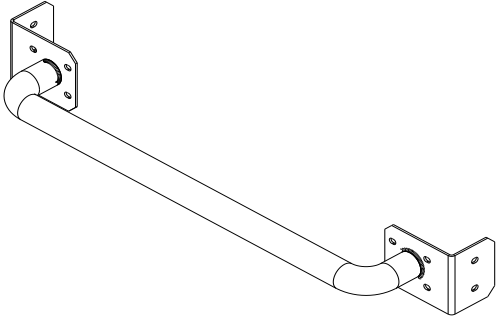

**(#9) PUSH BAR x 1 PC**

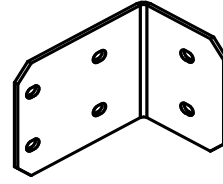

**(#9-B) CORNER BRACKET x 2 PCS**

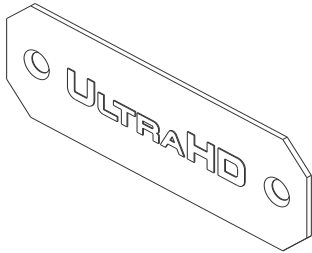

**(#14) LOGO PLATE x 1 PC**

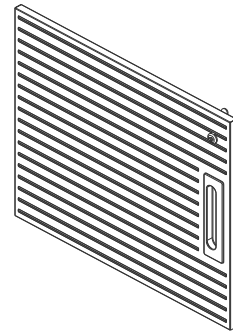

**(#20-A) LEFT DOOR x 1 PC**

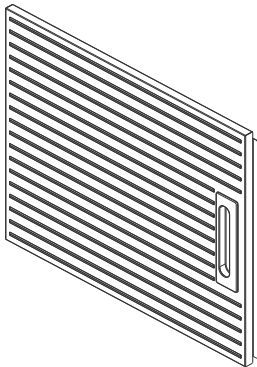

**(#20-C) MIDDLE DOOR x 1 PC**

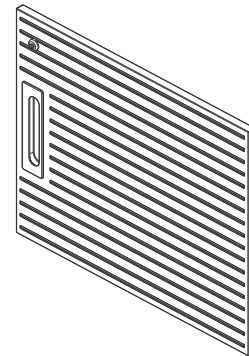

**(#20-B) RIGHT DOOR x 1 PC**

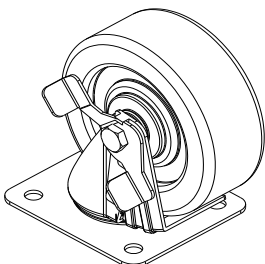

**(#12-B) WHEEL WITH BRAKE x 2 PCS**

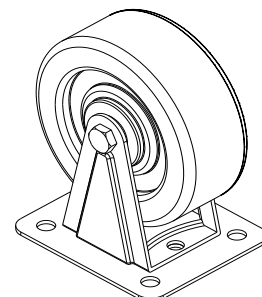

**(#13-B) WHEEL W/O BRAKE x 2 PCS**

# PARTS LIST

Please check the parts carefully according to the parts list. If you are missing any parts, please contact our customer service department (please refer to page 16).

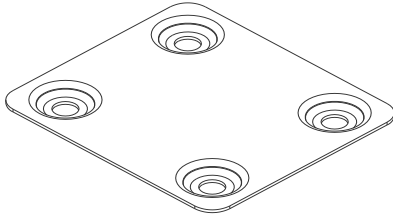

**(#29) CASTER SEAT CUSHION x 4 PCS**

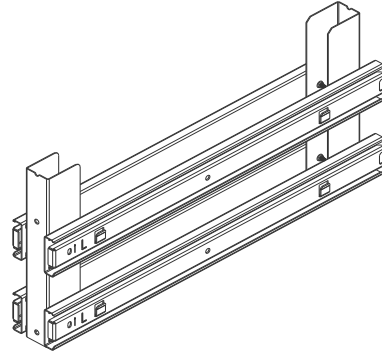

**(#27) RIGHT SIDE SLIDER SUPPORT x 1 PC**

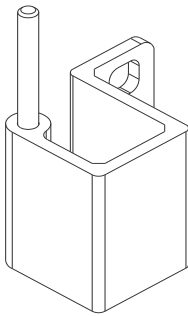

**(#19-A) LEFT SIDE DOOR HINGE x 4 PCS**

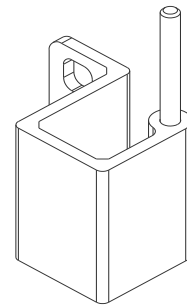

**(#19) RIGHT DOOR HINGE x 2 PCS**

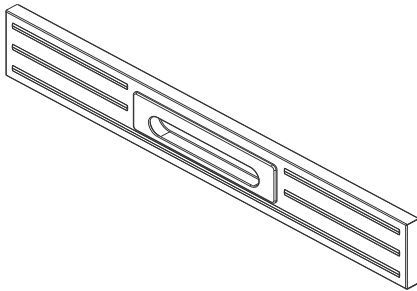

**(#26-1) SMALL DRAWER FRONT x 6 PCS**

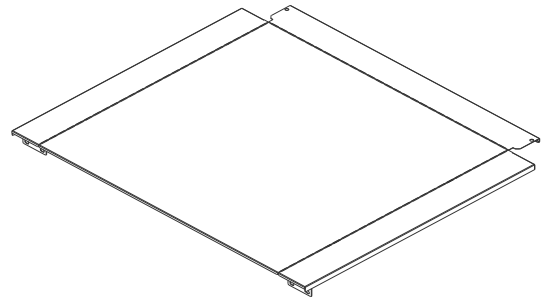

**(#26-2) SMALL DRAWER CASE x 6 PCS**

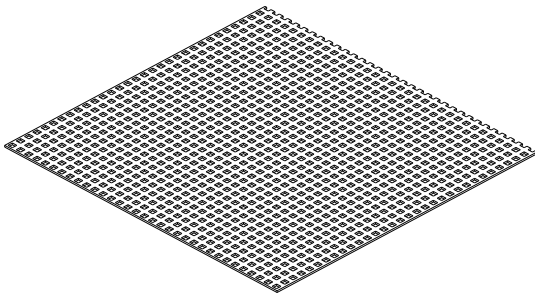

**(#24) DRAWER MAT x 6 PCS**

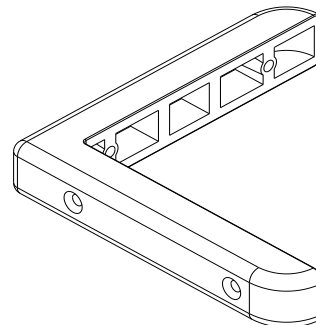

**(#57) BUMPER x 4 PCS**

# PARTS LIST

Please check the parts carefully according to the parts list. If you are missing any parts, please contact our customer service department (please refer to page 16).

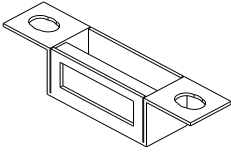
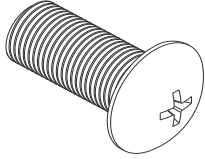
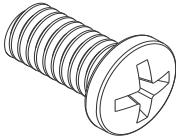
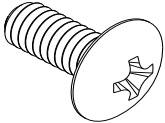
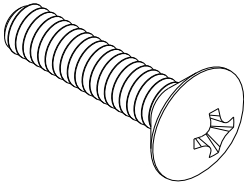
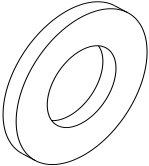
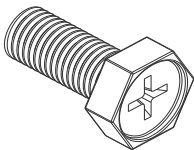
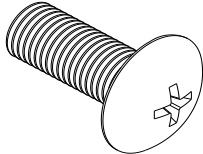
	
<p><b>(#23) MAGNET x 3 PCS</b></p>	<p><b>(#17) SCREW D ( M8 x 18L) x 16 PCS</b></p>
	
<p><b>(#15) SCREW B (M4 x 8L) x 78 PCS</b></p>	<p><b>(#41) SCREW F (M4 x 8L) x 100 PCS</b></p>
	
<p><b>(#42) SCREW G (M4 x 30L) x 16 PCS</b></p>	<p><b>(#27-B) WASHER (M8) x 14 PCS</b></p>
	
<p><b>(#40) SCREW E (M8 x 18L) x 8 PCS</b></p>	<p><b>(#50) SCREW I (M6 x 15L) x 6 PCS</b></p>



## PARTS LIST

Please check the parts carefully according to the parts list. If you are missing any parts, please contact our customer service department (please refer to page 16).

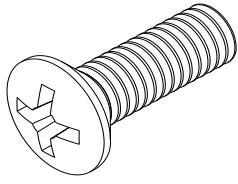

**(#54) Screw N (M4 x 10L) x 2 PCS**

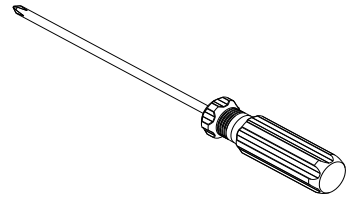

**(#21) SCREW DRIVER x 1 PC**

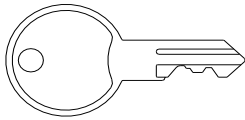

**(#22) KEY x 8 PCS**

# ASSEMBLY INSTRUCTIONS

## UltraHD Rolling Work Center (Model No. 20118)

**TIP:** A magnetic screwdriver is included for your convenience. If a power screwdriver is used, keep on a low torque setting.

### **Step 1.** Install Wood Top (#8).

Place Left Wood Top (#8-A), Right Wood Top (#8-B) and Wood Top Connection (#8-C) on top of cardboard to reduce the chance of scratching during assembly. Use 6 pcs of Washers (#27-B) and 6 pcs of Screw I (#50) to secure the wood tops on the connection.

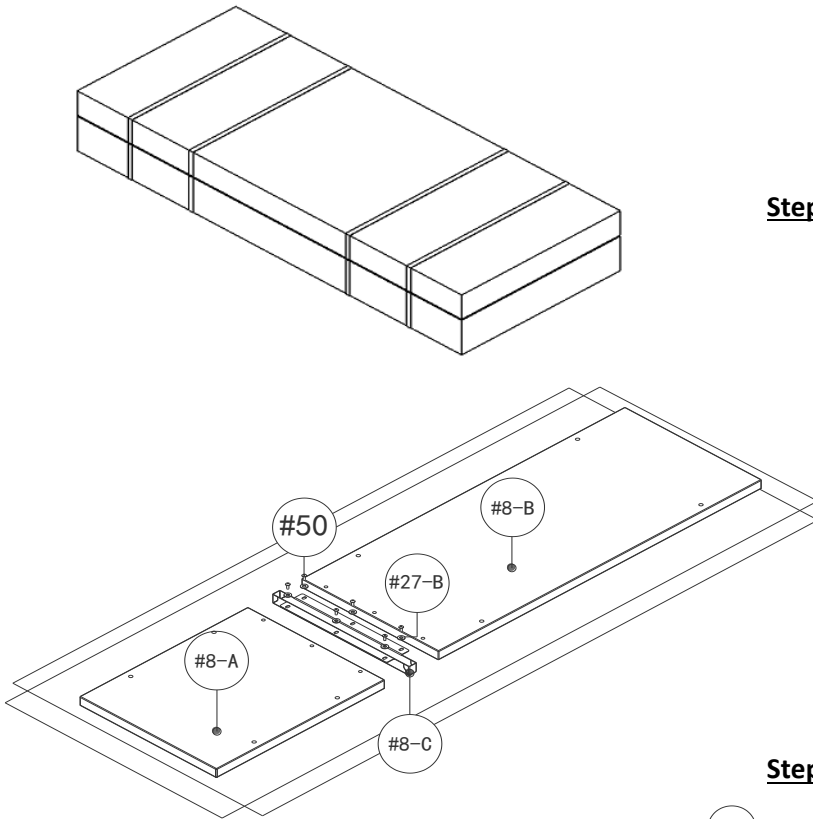

### **Step 2.** Install Front Frame (#3).

Insert the Upper Connection Bracket (#3-C) and Connection Bracket (#3-D) into the Left Front Frame (#3-A) and Right Front Frame (#3-B), aligning the screw holes. Place the Logo Plate (#14) on the front side of the Front Frame (#3), secure them with 2 pcs of Screw F (#54). And use 4 pcs of Screw F (#41) to secure the back side. Then use 2 pcs of Screw F (#41) to secure the connection brackets.

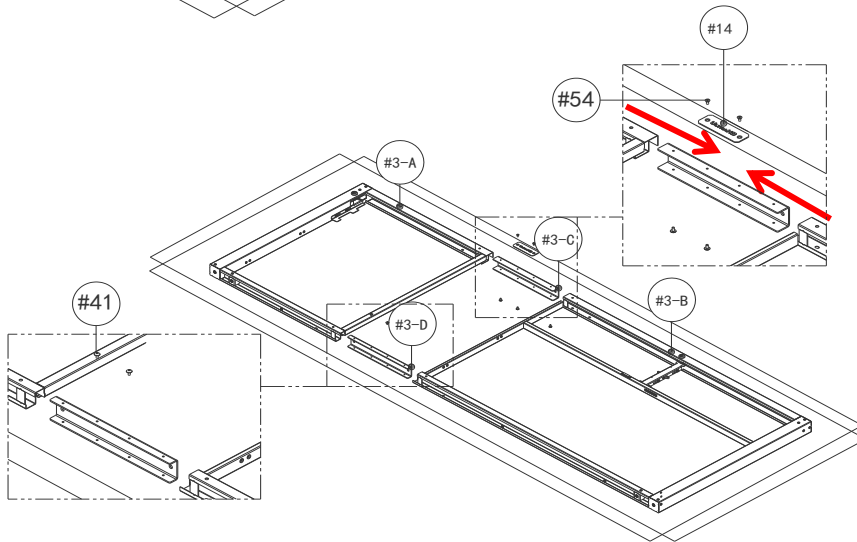

### **Step 3.** Install Back Frame (#4).

Insert 2 pcs Connection Bracket (#3-D) into the Left Back Frame (#4-A) and Right Back Frame (#4-B), align the screw holes and use 4 pcs of Screw F (#41) to secure. Then use 2 pcs of Screw F (#41) to secure the Connection Brackets (#3-D).

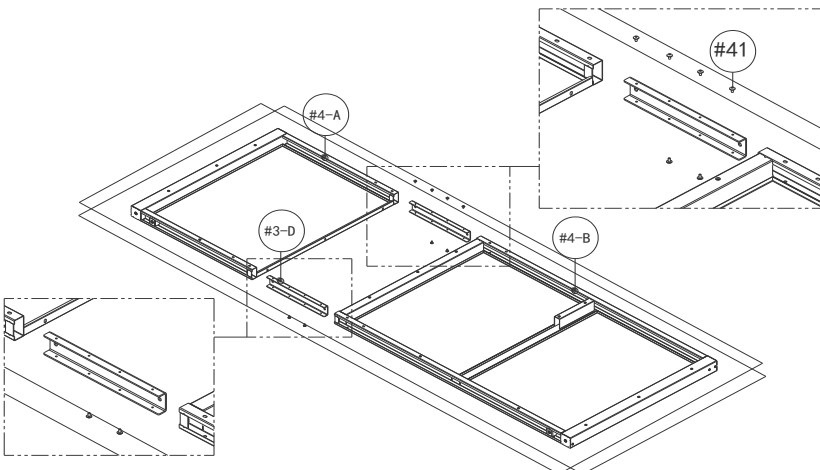

# ASSEMBLY INSTRUCTIONS

## UltraHD Rolling Work Center (Model No. 20118)

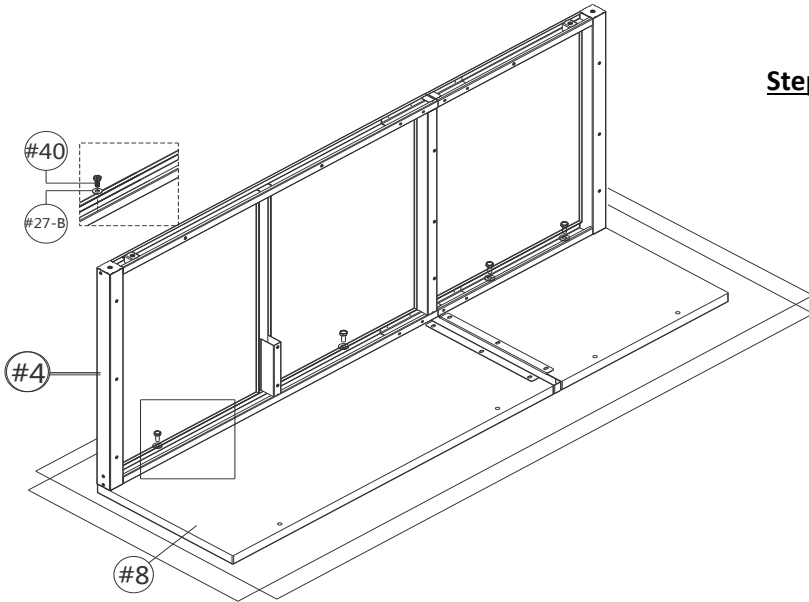

**Step 4. Install Back Frame (#4) to Solid Hardwood Top (#8).**

Place the Back Frame (#4) as the image shows. Secure with 4 pcs of Screw E (#40) and 4 pcs of Washers (#27-B).

**Note: Do not fully tighten the screws in this step.**

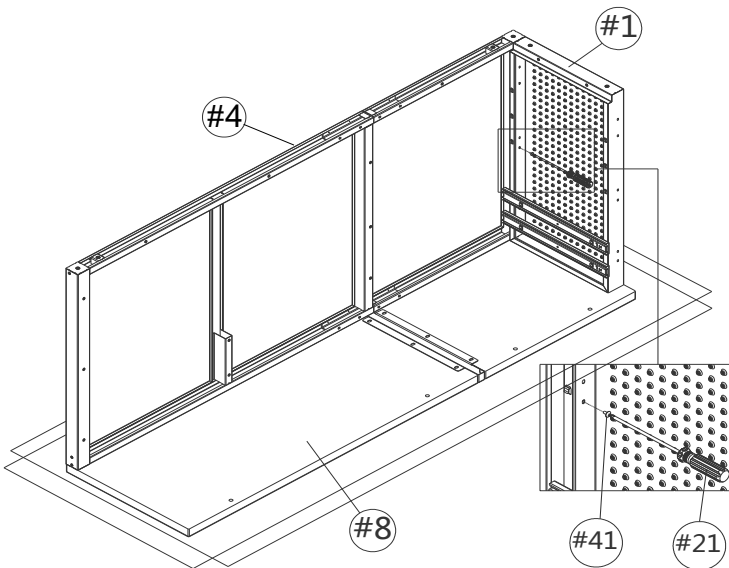

**Step 5. Install Left Side Panel (#1).**

Attach the Left Side Panel (#1) to the Back Frame (#4). Align the screw holes, then secure with 3 pcs of Screw F (#41).

**Note: Please tighten the screws in this step.**

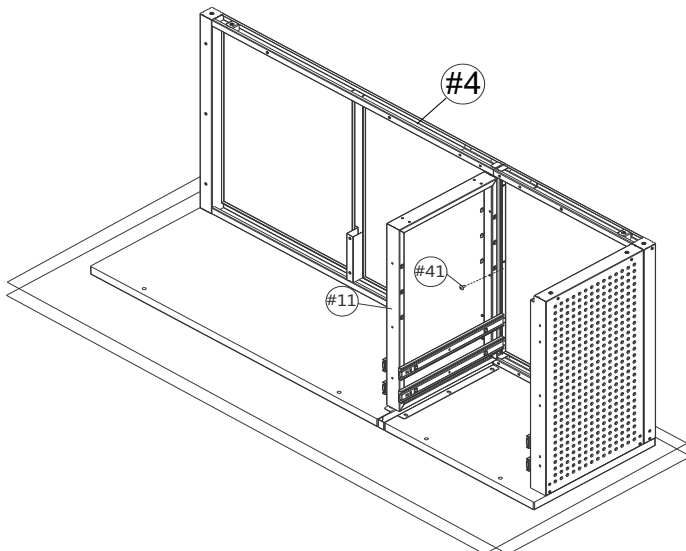

**Step 6. Install Left Side Slider Support (#11).**

Attach the Left Side Slider Support (#11) to the Back Frame (#4). Align the screw holes, then secure with 3 pcs of Screw F (#41).

**Note: Please tighten the screws in this step.**

# ASSEMBLY INSTRUCTIONS

## UltraHD Rolling Work Center (Model No. 20118)

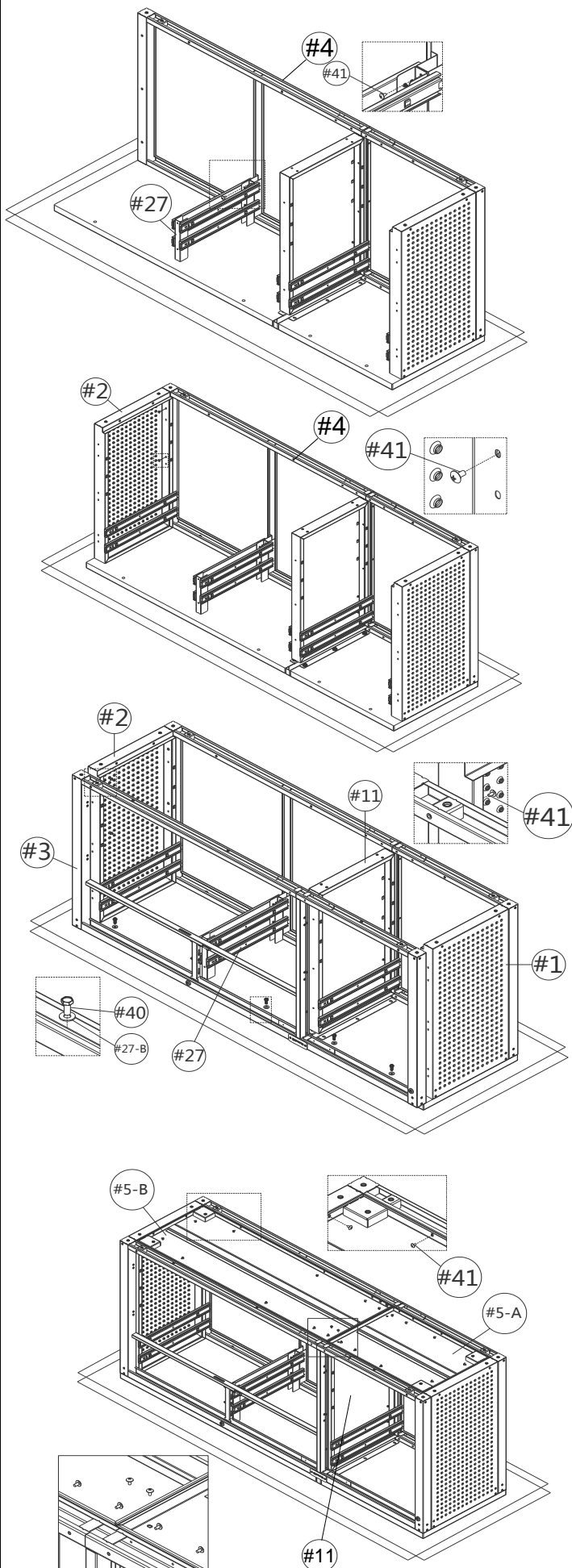

### **Step 7. Install Right Side Slider Support (#27).**

Attach the Right Side Slider Support (#27) to the Back Frame (#4). Align the screw holes, then secure with 2 pcs of Screw F (#41).

**Note: Please tighten the screws in this step.**

### **Step 8. Install the Right Side Panel (#2).**

Attach the Right Side Panel (#2) to the Back Frame (#4). Align the screw holes, then secure with 3 pcs of Screw F (#41).

**Note: Please tighten the screws in this step.**

### **Step 9. Install Front Frame (#3).**

Place the Front Frame (#3) on the Wood Top (#8) as the image shows. Secure with 4 pcs of Screw E (#40) and 4 pcs of Washers (#27-B). **Do not fully tighten the screws.**

Then use 11 pcs of Screw F (#41) to secure the Right Side Panel (#2), the Right Side Slider Support (#27), the Left Side Slider Support (#11) and the Left Side Panel (#1) on the Front Frame (#3).

Align the cabinet edges with tabletop, then **tighten all the screws on both frames.**

### **Step 10. Install Left Bottom Panel (#5-A) and Right Bottom Panel (#5-B)**

Place the Left Bottom Panel (#5-A) and the Right Bottom Panel (#5-B) as the image shows. Use 14 pcs of Screw F (#41) to secure bottom panels on the frames and 4 pcs of Screw F (#41) to secure them on the side panels. **Do not fully tighten the screws.**

Use 4 pcs of Screw F (#41) to secure bottom panels on the Left Side Slider Support (#11). **Tighten all the screws in this step.**

# ASSEMBLY INSTRUCTIONS

## UltraHD Rolling Work Center (Model No. 20118)

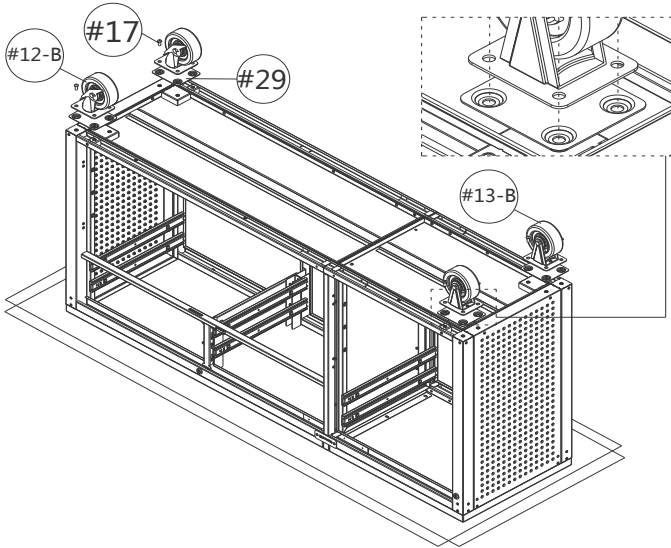

### **Step 11. Install Caster Seat Cushion (#29) and Wheels (#12-B & #13-B)**

Attach 4 pcs of (#29) Caster Seat Cushion and 4 pcs of Wheels (#12-B & #13-B) on the frame as shown in left picture. Secure with 16 pcs of Screws D (#17).

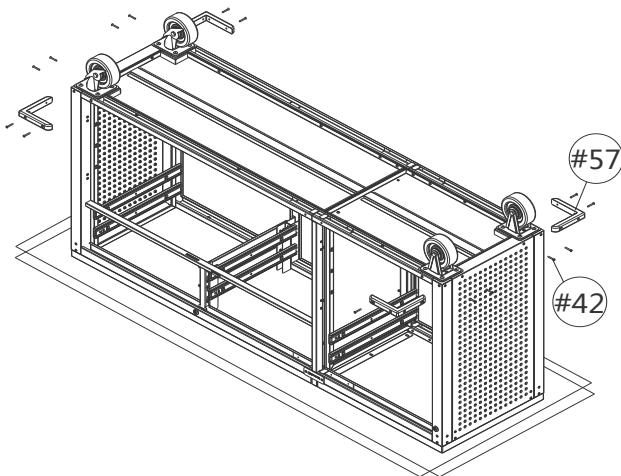

### **Step12. Install Bumpers (#57)**

Attach Bumpers (#57) to the bottom four corners of the Work Center. Secure with 16 pcs of Screw G (#42). Then, rotate/stand the Work Center upright.

**Note:** When installing the bumpers, tighten the screw until it is slightly recessed below the surface of the guard. Be careful not to overtighten.

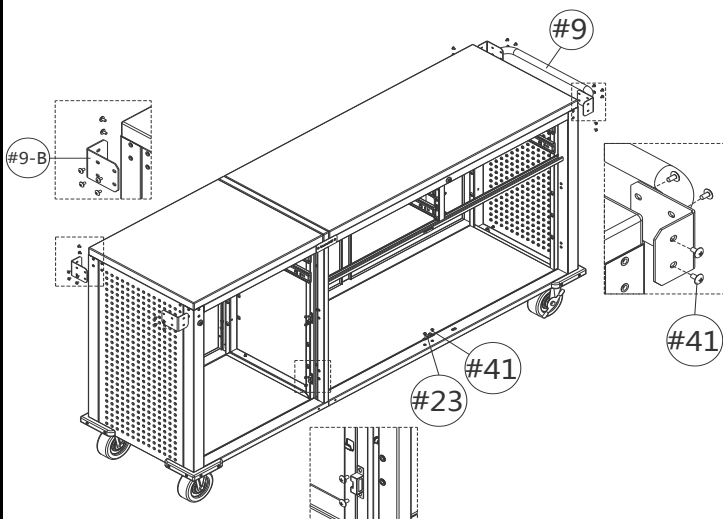

### **Step13. Install Push Bar (#9), Corner Bracket (#9-B) and Magnet (#23)**

A. Attach the Push Bar (#9) on one of the Side Panel (#1 or #2). Secure with 12 pcs of Screw F (#41).

B. Attach the Corner Bracket (#9-B) on the other Side Panel (#1 or #2). Secure with 12 pcs of Screw F (#41).

C. Attach 3 pcs Magnets (#23) to the Front Frame (#3) as the image shows. Secure with 6 pcs of Screew F (#41).

# ASSEMBLY INSTRUCTIONS

## UltraHD Rolling Work Center (Model No. 20118)

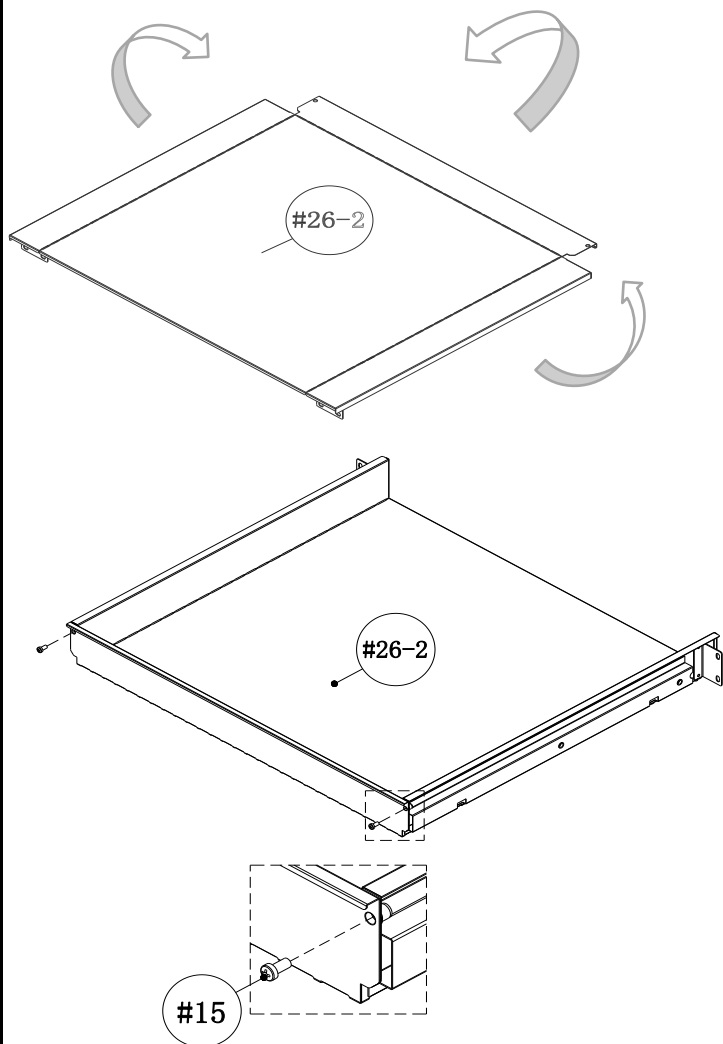

### **Step 14. Install Drawers.**

A. Fold up all the Drawer Case (#26-2) as the image shows.

B. Use 2 pcs of Screw B (#15) to tighten the back panel to the drawer left and right panels.

**Note:** Do not tighten the screws all the way, until part C is completed.

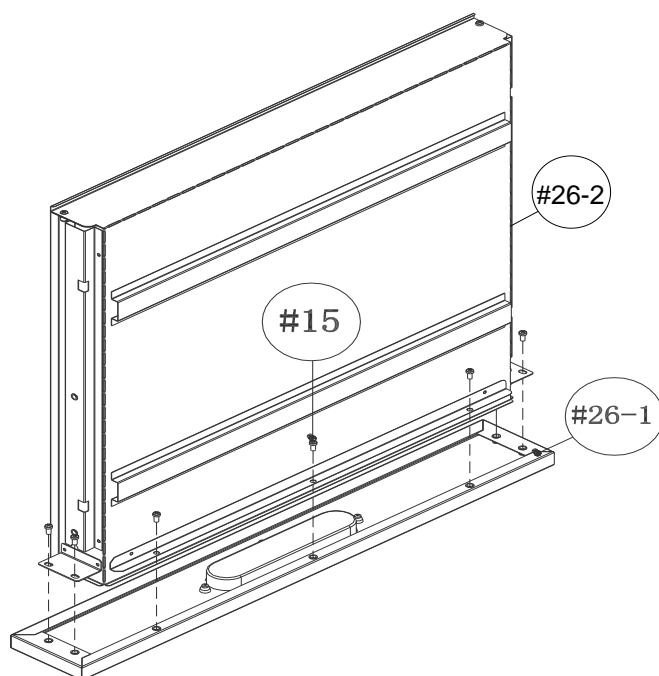

C. Slide the Drawer Case (#26-2) into Small Drawer Front (#26-1) as the detail picture shows. Secure with 7 pcs of Screw B (#15).

**NOTE:** Once all the drawer panels are aligned, tighten all the drawer screws.

# ASSEMBLY INSTRUCTIONS

## UltraHD Rolling Work Center (Model No. 20118)

### Step 15. Place the Drawers.

First, fully extend the sliders from the bottom track. Place the Drawer (#26) from top to bottom onto sliders as shown in the image. Ensure the square holes on the drawer side panels are line up, and the drawer hooks on the sliders. Then secure with 4 pcs of Screw B (#15). Repeat this installation process for the remaining drawers. Finally, place the Drawer Mat (#24) in each of the drawers.

**Note: If gaps appear between drawers after installation, loosen the inner rail screws to adjust the drawer position vertically.**

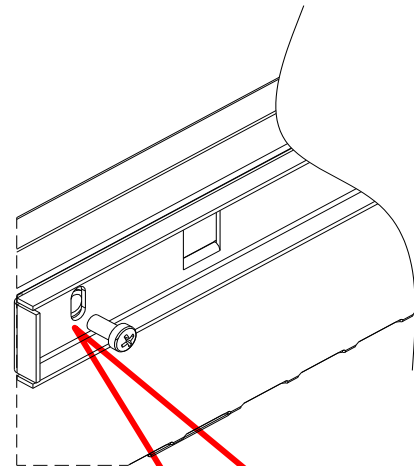
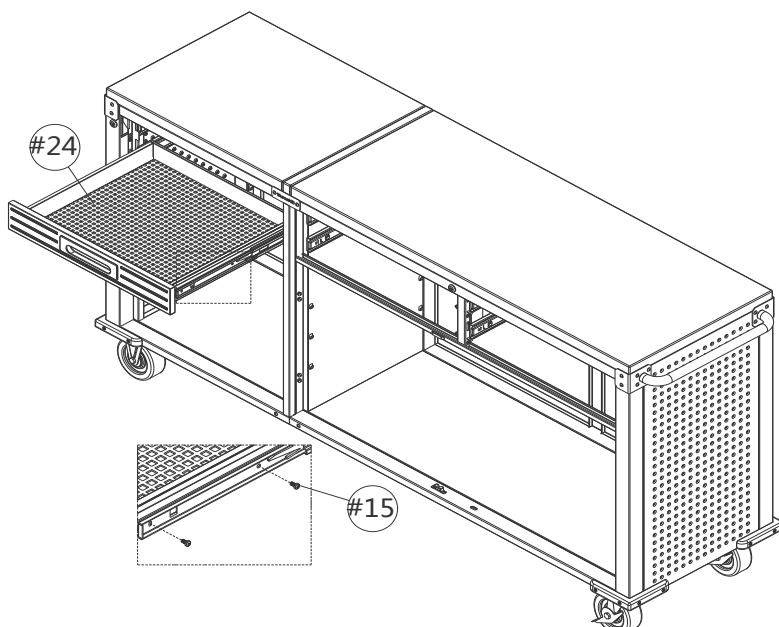
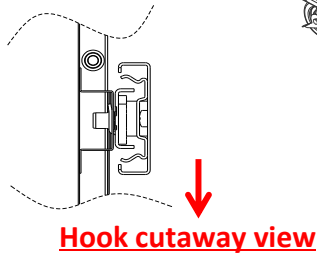
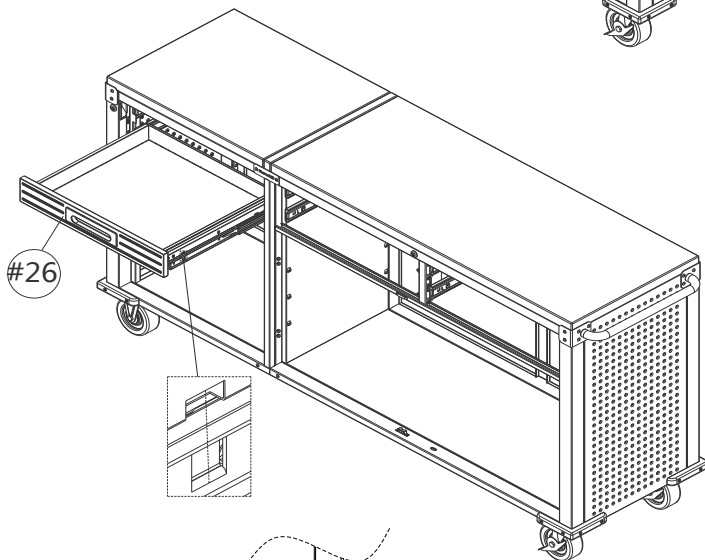
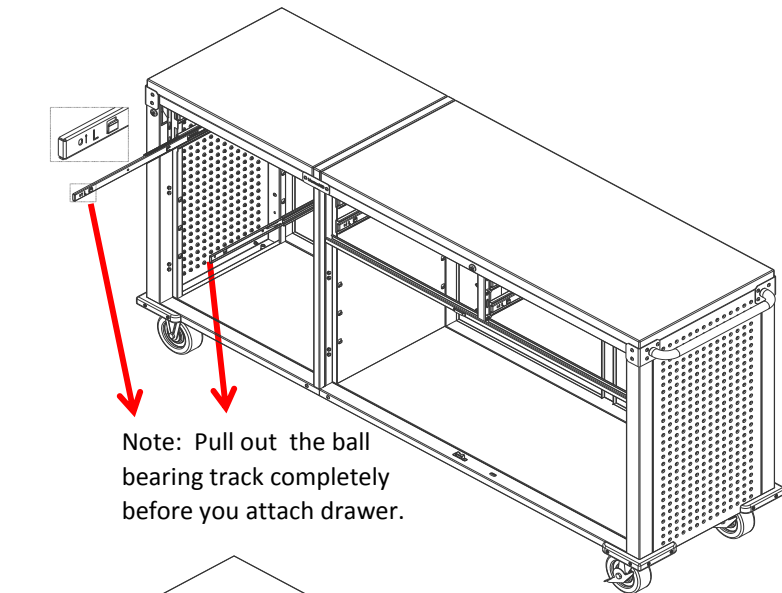

The oval hole at the front of the slider allows for the gaps between the drawers to be adjusted. Make the adjustments once all the drawers are installed.

### CAUTION



Only open one drawer at a time to avoid tipping. 30 lbs. maximum loading for ea drawer.

Total Weight Capacity Evenly Distributed	Weight Capacity per drawer Evenly Distributed
500 lbs. (227kg)	30 lbs. (13.61kg)

# ASSEMBLY INSTRUCTIONS

## UltraHD Rolling Work Center (Model No. 20118)

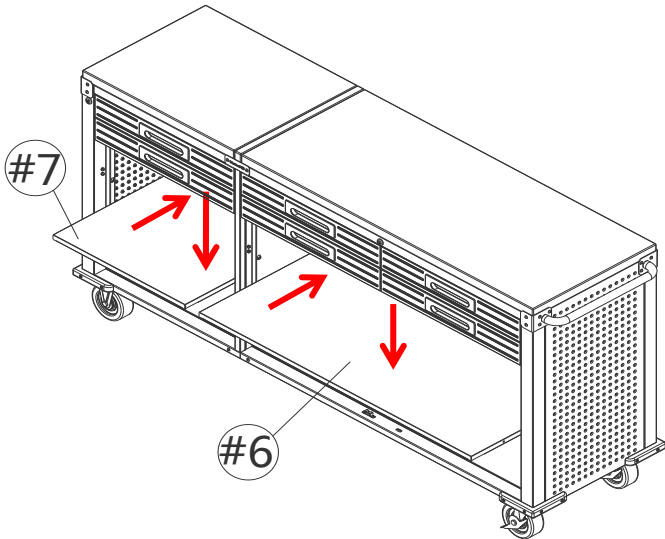

### **Step 16. Install Shelf (#6) and Left Middle Shelf (#7).**

Tilt and install the shelves (#6 & #7) into the work center. Hang them securely on the hooks.

**Note: The height of shelves can be adjusted by repositioning the hooks.**

### **Step 17. Install Left Door (#20-A), Middle Door (#20-C) and Right Door (#20-B).**

Install hinges to doors and secure to front frame: 2 pcs Left Side Door Hinge (#19-A) on Left Door (#20-A), 2 pcs Left Side Door Hinge (#19-A) on Middle Door (#20-C), and 2 pcs Right Hinge (#19) on Right Door (#20-B), then fasten each door to its corresponding front frame position using 4 pcs of Screw F (#41) per door.

**Note: The hinge screw holes allow for adjustment, enabling precise door alignment within the frame.**

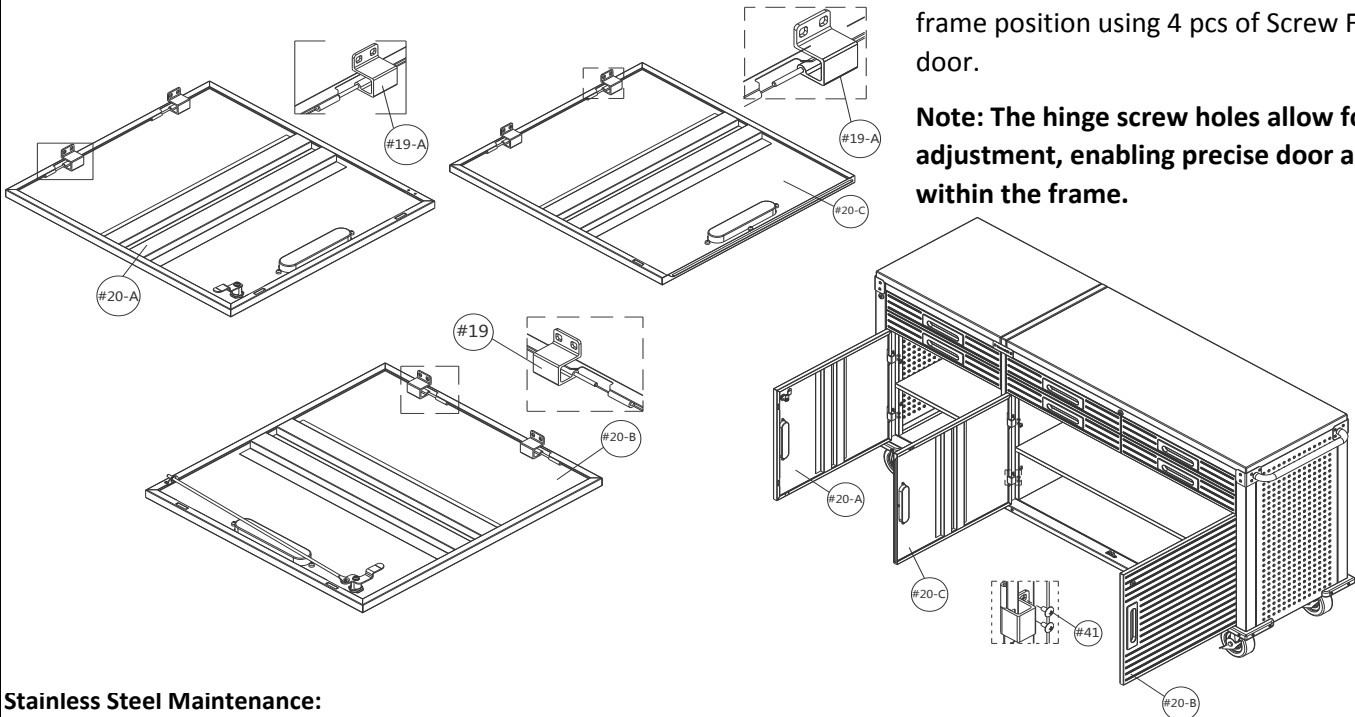

### **Stainless Steel Maintenance:**

These parts have an UltraGuard™ fingerprint resistant finish. Do not use traditional stainless steel cleaners on this unit. Lightly wipe off once a month with clean warm water and a soft cloth (preferably a micro fiber cloth). This is the safest formula to prevent new stains from appearing over time and manage unwanted fingerprints or grease marks. Remember to always wipe in the direction of the surface grain (NEVER ACROSS) and always use a lint-free cloth. Once the surface is clean, thoroughly wipe dry with a soft absorbent cloth.

### **UltraHD Wood Top**

Although great care is taken to hand select consistent wood top color and grain for UltraHD products, there can and will be natural variations in color and graining between finished products. These variations contribute to the beauty of using a natural material as a work workcenter and are considered standard quality. Variations of color within these standards and minor scratches in the clear coat finish will not be a reason for replacement. If the wood top is received with excessive damage or splitting, Seville Classics will guarantee replacement of the wood top.

### **Restore Shallow Scratches or Chips**

If the wood top becomes scratched and chipped over time or during assembly, a Polyurethane finish can be applied to help restore the wood's natural texture, as well as protect the surface from future damage.

### **Applying a Polyurethane Coating**

Please follow the manufacturer's instruction on the product for application.



## CONTACT INFORMATION

If you are missing any parts, have any questions, or need additional assistance in assembly, please contact our bilingual (English and Spanish) customer service department at:



Seville Classics, Inc.

19401 Harborage Way Torrance, CA 90501 USA

Telephone: (800) 323-5565 within USA

Fax: (310) 533-3899

Hours: 8:30am - 4:30pm (Pacific Standard Time)

E-mail: [support@sevilleclassics.com](mailto:support@sevilleclassics.com)

Website & Online Store: [www.sevilleclassics.com](http://www.sevilleclassics.com)

**\*\*\*Please visit our website or call and inquire about our additional UltraHD® Line\*\*\***

## UltraHD® Line

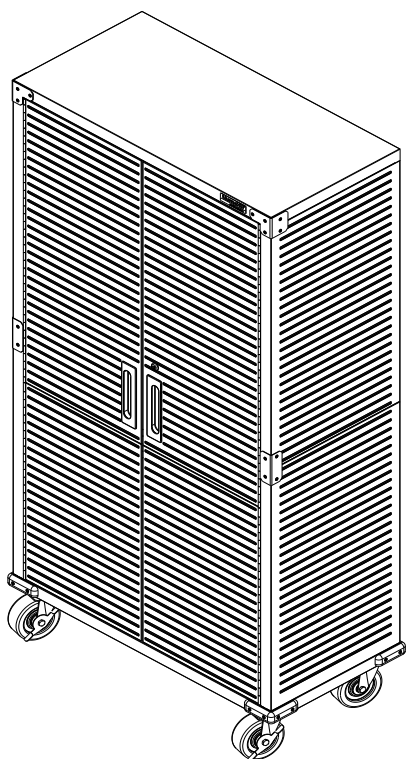

### **UltraHD® Tall Storage Cabinet**

**Model No. 16236 (Granite)**

**Model No. 20143 (Graphite)**

**Model No. 20153 (Red)**

**Model No. 20133 (White)**

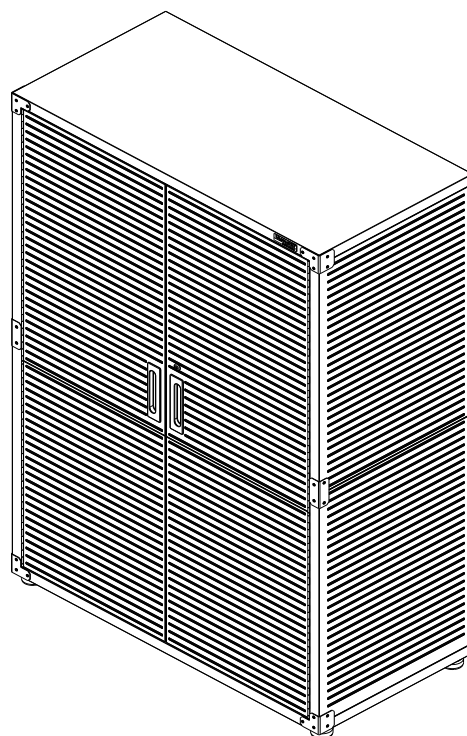

### **UltraHD® Mega Storage Cabinet**

**Model No. 16238 (Granite)**

**Model No. 20148 (Graphite)**

**Model No. 20158 (Red)**

**Model No. 20138 (White)**

# UltraHD® Line

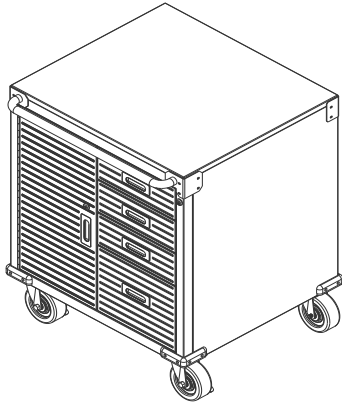

**UltraHD® Rolling Cabinet**  
Model No. 20225 (Granite)  
Model No. 20081 (Graphite)  
Model No. 20082 (Red)  
Model No. 20083 (White)

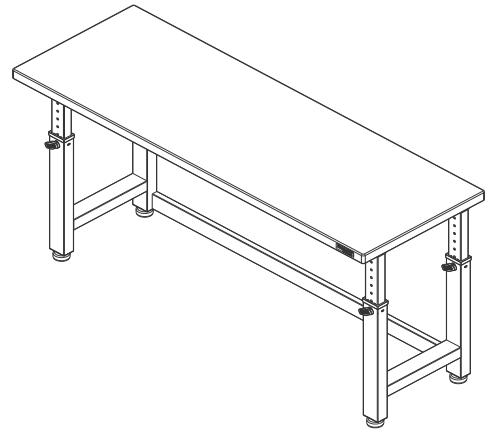

**UltraHD® 6-Foot Height Adjustable Workbench**  
Model No. 20292 (Granite)  
Model No. 20293 (Graphite)  
Model No. 20134 (Red)  
Model No. 20131 (White)

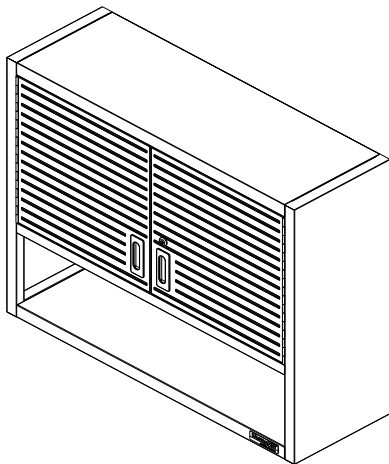

**UltraHD® Wall Cabinet with Open Shelf**  
Model No. 20230 (Granite)  
Model No. 20140 (Graphite)  
Model No. 20150 (Red)  
Model No. 20130 (White)

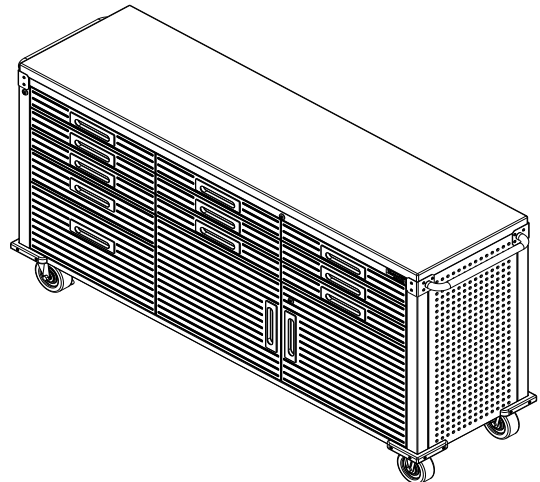

**UltraHD® 2-Door Rolling Workbench | Work Center**  
Model No. 20262 (Granite)  
Model No. 20142 (Graphite)  
Model No. 20152 (Red)  
Model No. 20132 (White)

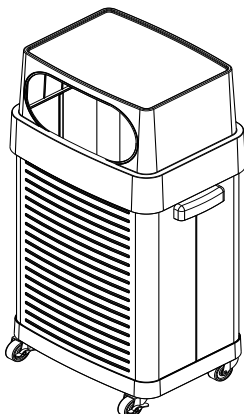

**UltraHD® Rolling Trash Bin**  
Model No. 20215

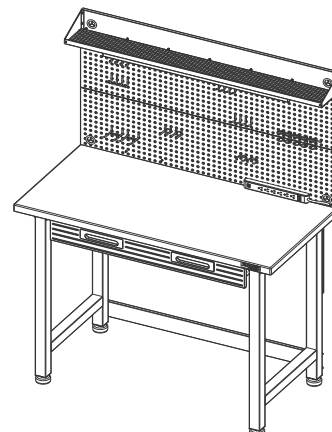

**UltraHD® Lighted Workcenter**  
Model No. 20247 (Granite)  
Model No. 20246 (Graphite)  
Model No. 20157 (Red)  
Model No. 20291 (White)