



# ASSEMBLY INSTRUCTIONS

## UltraHD® LED Lighted Work Center (Model No. 20282)

Graphite

45 in W X 22 in D X 50.6-64 in H  
(1143 mm x 558.8mm x 1285-1628 mm)

**ULTRAGUARD®**  
FINGERPRINT RESISTANT SURFACES  
AND INCREASED DURABILITY

Reference page 10 for special care and  
maintenance of stainless steel

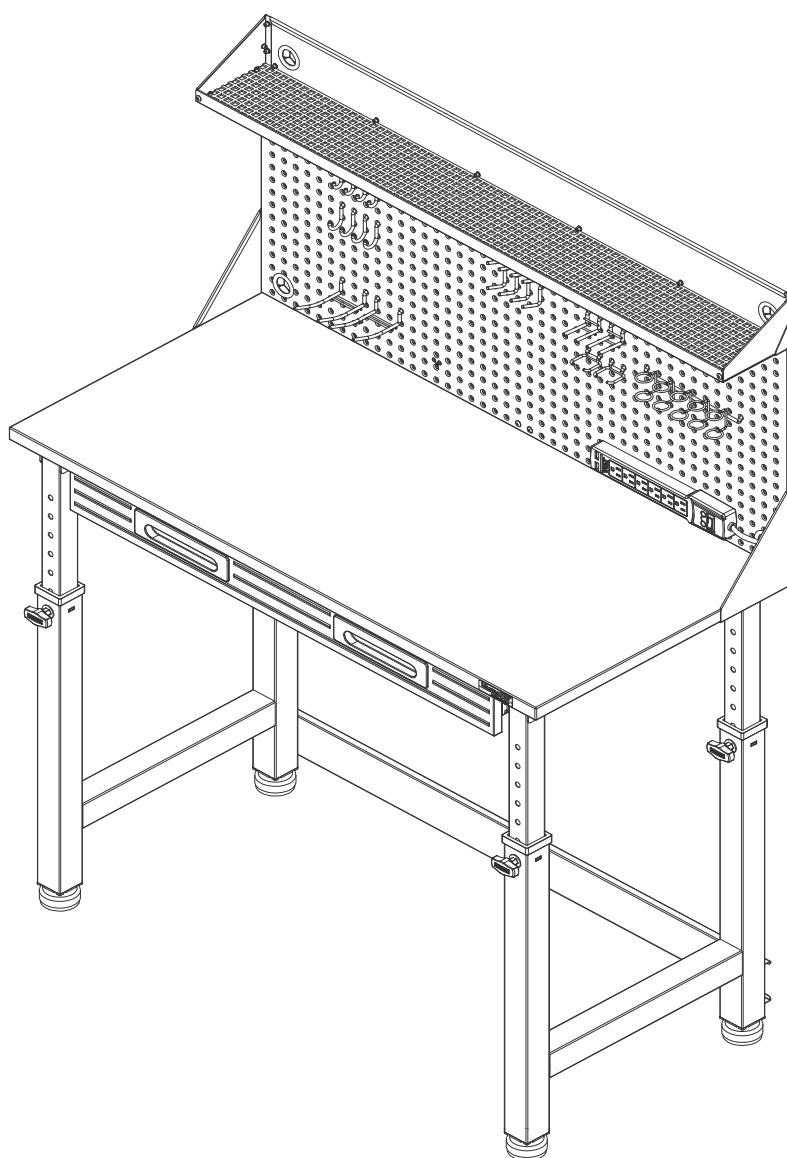

# PARTS LIST

Please check the parts carefully according to the parts list. If you are missing any parts, please contact our customer service department (please refer to page 12).

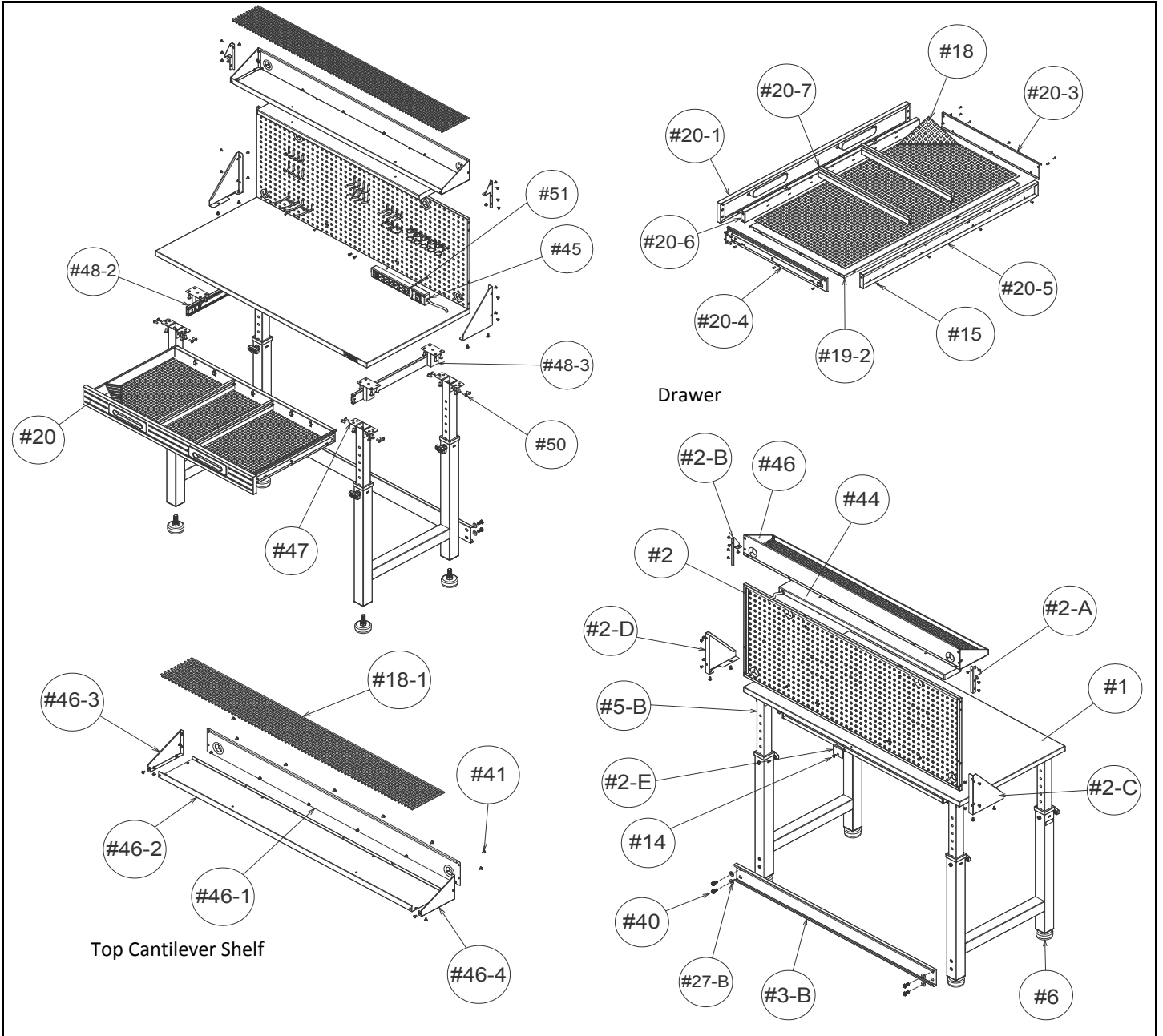

No.	Parts	Qty.
#1	SOLID HARDWOOD BOARD TOP	1PC
#2	PEGBOARD PANEL	1PC
#2-A	TOP CANTILEVER SHELF LEFT CROSSBAR	1PC
#2-B	TOP CANTILEVER SHELF RIGHT CROSSBAR	1PC
#2-C	PEGBOARD PANEL LEFT SUPPORT	1PC
#2-D	PEGBOARD PANEL RIGHT SUPPORT	1PC
#2-E	PEGBOARD PANEL MIDDLE SUPPORT	1PC
#3-B	BOTTOM CROSSBAR	1PC
#5-B	LEG PIECE	2PCS
#6	LEVELING FOOT	4PCS
#18	DRAWER MAT	1PC
#18-1	TOP CANTILEVER SHELF MAT	1PC
#19-2	DRAWER BASE PANEL	1PC
#20-1	DRAWER FRONT PANEL	1PC

No.	Parts	Qty.
#20-3	DRAWER LEFT PANEL	1PC
#20-4	DRAWER RIGHT PANEL	1PC
#20-5	DRAWER BACK PANEL	1PC
#20-6	DRAWER FRONT PANEL SUPPORT PLATE	1PC
#20-7	DRAWER DIVIDER	2PCS
#44	LED LAMP	1PC
#46-1	TOP CANTILEVER SHELF BACK PANEL	1PC
#46-2	TOP CANTILEVER SHELF BASE PANEL	1PC
#46-3	TOP CANTILEVER SHELF LEFT PANEL	1PC
#46-4	TOP CANTILEVER SHELF RIGHT PANEL	1PC
#47	"L" BRACKET	8PCS
#48-2	SMALL DRAWER LEFT SUPPORT	1PC
#48-3	SMALL DRAWER RIGHT SUPPORT	1PC

## PARTS LIST

Please check the parts carefully according to the parts list. If you are missing any parts, please contact our customer service department (please refer to page 12).



#100

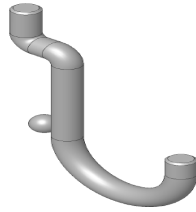

#101



#103

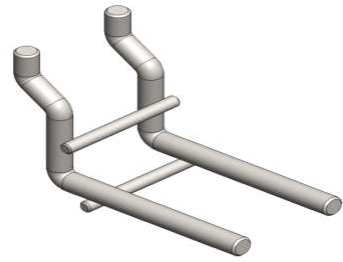

#104

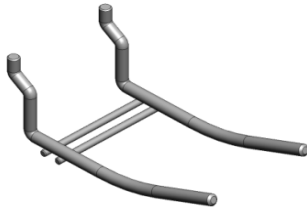

#105



#106



#107

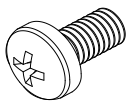

#15

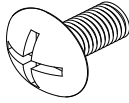

#50

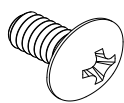

#14

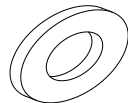

#27-B

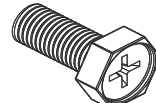

#40

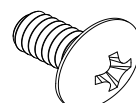

#41

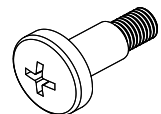

#51

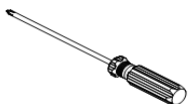

#21

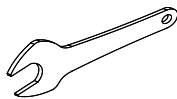

#25

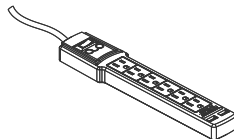

#45



#4

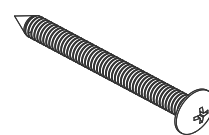

#55

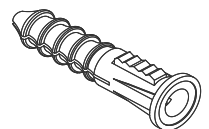

#55-A

No.	Parts	Qty.	No.	Parts	Qty.
#14	SCREW N (M4 x 10L)	5PCS	#50	SCREW I (M6 x 15L)	48PCS
#15	SCREW B (M4 x 8L)	30PCS	#100	1/2" CURVED HOOK	4PCS
#21	SCREWDRIVER	1PC	#101	1" CURVED HOOK	4PCS
#25	WRENCH	1PC	#103	1.5" STRAIGHT HOOK	8PCS
#27-B	WASHER	4PCS	#104	2" DOUBLE PRONG HOOK	2PCS
#40	SCREW E (M8 x 18L)	4PCS	#105	4" CURVED DOUBLE PRONG HOOK	2PCS
#41	SCREW F (M4 x 8L)	32PCS	#106	2" PLIER HOLDER HOOK	2PCS
#51	STUD SCREW J (M3 x 10L)	4PCS	#107	2" MULTI-TOOL HOLDER HOOK	1PCS
#45	POWER STRIP W. USB PORTS	1PC	#4	SPACER	4PCS
#55	SCREW M (M6 x 50L)	4PCS	#55-A	PLASTIC ANCHOR	4PCS

# UltraHD® LED Lighted Work Center (Model No. 20282)



\*NOTE: We recommend TWO people to assemble the workbench.



**TIP:** A magnetic screwdriver is included for convenience. If using a power screwdriver, keep torque setting LOW.

## Step 1. Adjust the height of the (#5-B) Leg Piece.

**A.** Open the package and make sure there are no missing parts. Take out (#5-B) Leg Piece and remove the Hand Knobs on each piece. Adjust both (#5-B) Leg Pieces to your desired height from 28.5 in. to 42 in.

**B.** Insert all 4 Hand Knobs and washers back into the leg tubes then tighten.

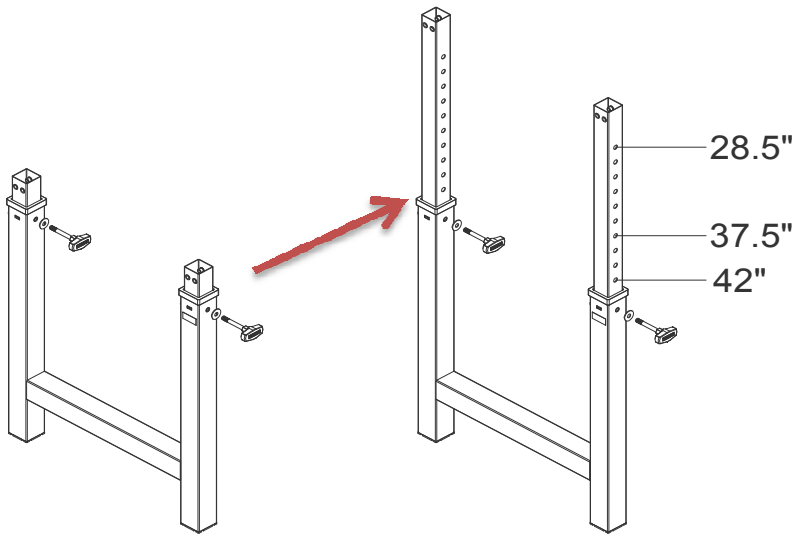

## Step 2. Install (#5-B) Leg Pieces.

**A.** Attach the (#47) "L" Bracket to the (#5-B) Leg Piece, use 16pcs of (#50) Screw I to tighten. Repeat Step A and install (#47) "L" Brackets to the other (#5-B) Leg Piece.

**NOTE:** Do not fully tighten the screws. This will help you make any adjustments for alignment.

**B.** Attach the (#5-B) Leg Pieces to the back of the (#1) Solid Hardwood Board Top, line up the screw holes, use 16pcs of (#50) Screw I to tighten.

**C.** Then, fully tighten all screws for this step.

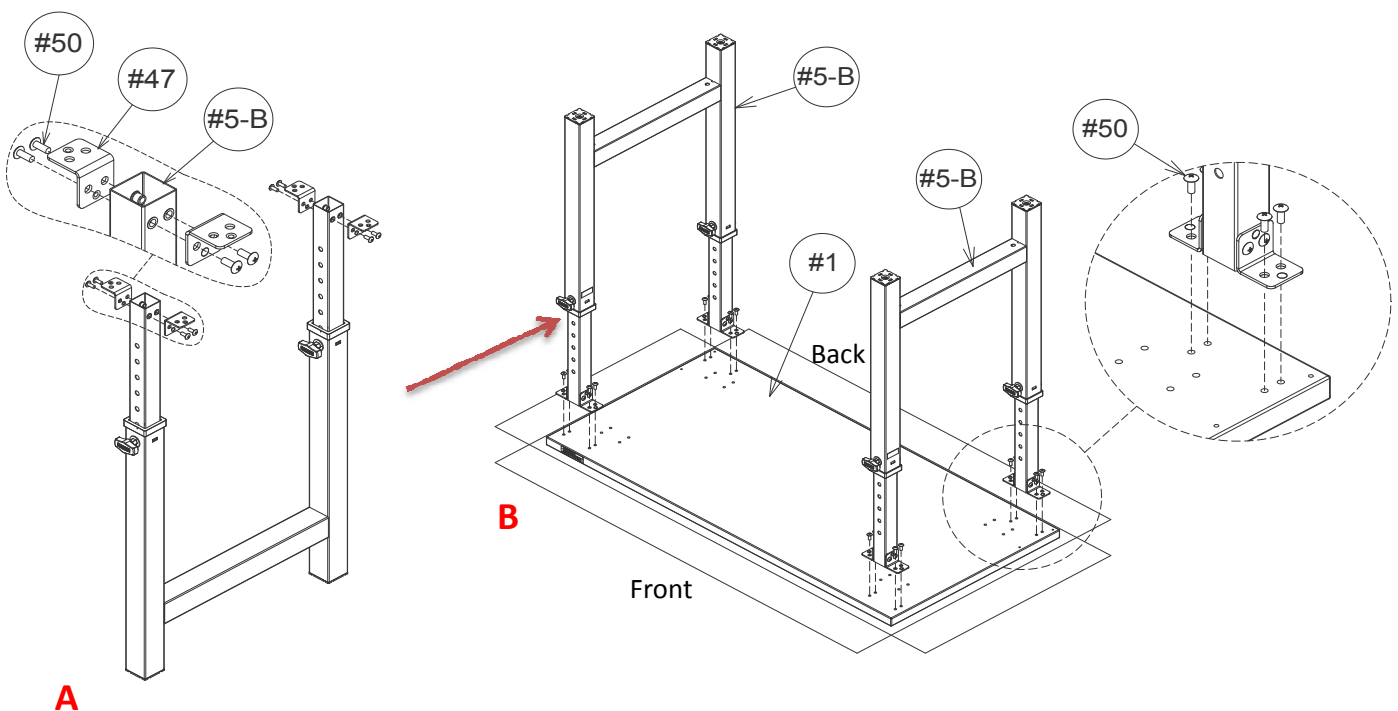



# UltraHD® LED Lighted Work Center (Model No. 20282)



\*NOTE: We recommend TWO people to assemble the workbench.



## Step 3. Install (#48-2) Small Drawer Left Support, (#48-3) Small Drawer Right Support.

A. Attach the (#48-2) Small Drawer Left Support to the bottom of (#1) Solid Hardwood Board, line up with the screw holes, use 16pcs of (#50) Screw I to tighten. Repeat this step to install (#48-3) Small Drawer Right Support.

Please be sure not to install the left and right support upside down. Once finished, the slides of the left and right support will be inside.

**NOTE: Do not fully tighten the screws. This will help you make any adjustments for alignment.**

## Step 4. Install (#3-B) Bottom Cross Bar and (#6) Leveling Feet.

A. Attach the (#3-B) Bottom Cross Bar to the back of (#5-B) Legs, line up the screw holes, use 4pcs of (#40) Screw E with 4pcs of (#27-B) Washer and use (#21) Screwdriver to tighten.

B. After installing (#3-B) Bottom Cross Bar, attach (#6) Leveling Feet to (#5-B) Leg Pieces, use (#25) Wrench to tighten.

**NOTE: Turn the workbench upright once you finish this step.**

## Step 5. Install (#2-C) Pegboard Panel Left Support and (#2-D) Pegboard Panel Right Support.

A. Attach the (#2-C) Pegboard Panel Left Support and (#2-D) Pegboard Panel Right Support to two sides of (#1) Solid Hardwood Board, line up the screw holes, use 4pcs of (#14) Screw N to tighten.

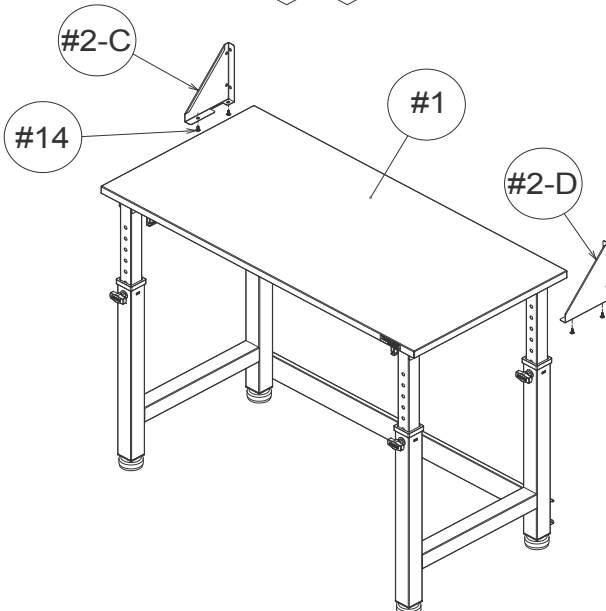
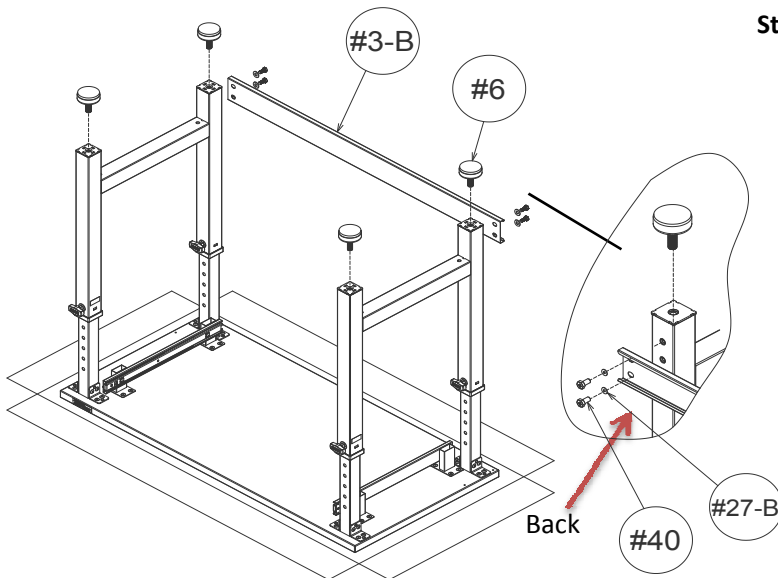
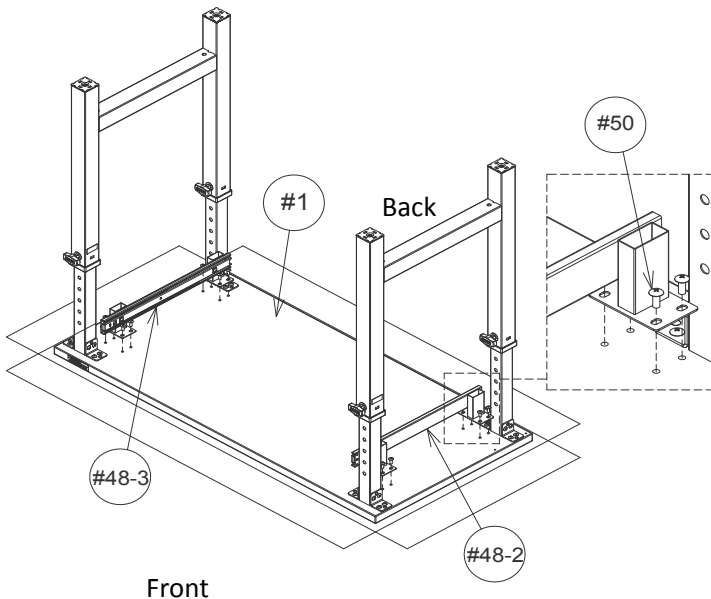

# UltraHD® LED Lighted Work Center (Model No. 20282)



\*NOTE: We recommend TWO people to assemble the workbench.



## Step 6. Install (#2) Pegboard Panel.

**A.** Attach (#2) Pegboard Panel along the back top edge of workbench and against (#2-C) Pegboard Panel Left Support and (#2-D) Pegboard Panel Right Support, line up the screw holes, use 8pcs of (#41) Screw F to tighten.

## Step 7. Install (#2-A) Top Cantilever Shelf Left Crossbar, (#2-B) Top Cantilever Shelf Right Crossbar and (#2-E) Top Cantilever Shelf Middle Crossbar.

**A.** Attach (#2-A) Top Cantilever Shelf Left Crossbar, (#2-B) Top Cantilever Shelf Right Crossbar to the (#2) Pegboard Panel, line up the screw holes, use 4pcs of (#41) Screw F to tighten.

**B.** Attach (#2-E) Top Cantilever Shelf Middle Crossbar to the back of the (#2) Pegboard Panel, line up the screw holes with Solid Hardwood Board Top. use 1pc of (#41) Screw F to tighten.

**NOTE: Do not fully tighten the screws.**

**C.** Use 2pcs of (#41) Screw F to tighten (#2-E) Top Cantilever Shelf Middle Crossbar from the front of the (#2) Pegboard Panel.

## Step 8. Install (#46) Top Cantilever Shelf.

**A.** Attach the (#46-3) Top Cantilever Shelf Left Panel and the (#46-4) Top Cantilever Shelf Right Panel to both ends of (#46-2) Top Cantilever Shelf Base Panel. Use 4pcs of (#41) F screws to tighten.

**NOTE: Do not fully tighten the screws. This will help you make any adjustments for alignment later.**

**B.** Make sure to slide the (#46-1) Top Cantilever Shelf back panel underneath the edge of (#46-2) Top Cantilever Shelf Base Panel. Use 8pcs (#41) F screws to tighten.

**A**

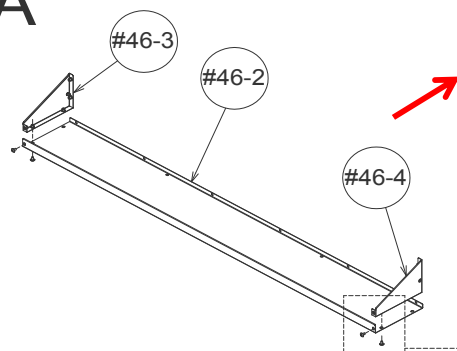

**B**

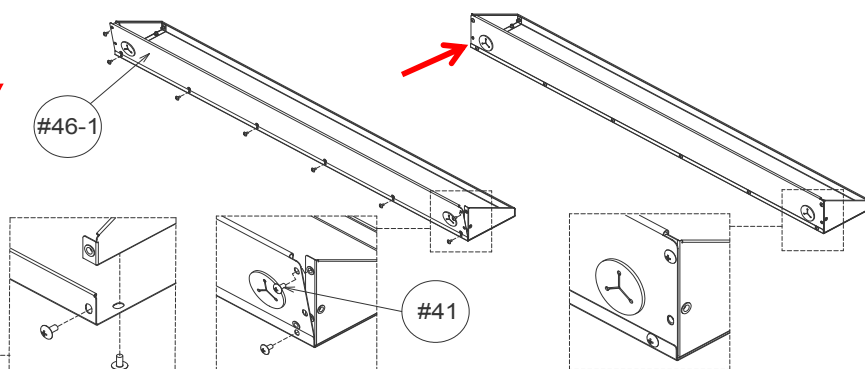

# UltraHD® LED Lighted Work Center (Model No. 20282)



\*NOTE: We recommend TWO people to assemble the workbench.



## Step 9. Install Assembled (#46) Top Cantilever Shelf to workbench.

A. Attach assembled (#46) Top Cantilever Shelf to (#2) Pegboard Panel, line up the screw holes, use 6pcs of (#41) Screw F and 2pcs of (#15) Screw B to tighten.

**NOTE: Do not fully tighten the screws. This will help you make any adjustments for alignment later.**

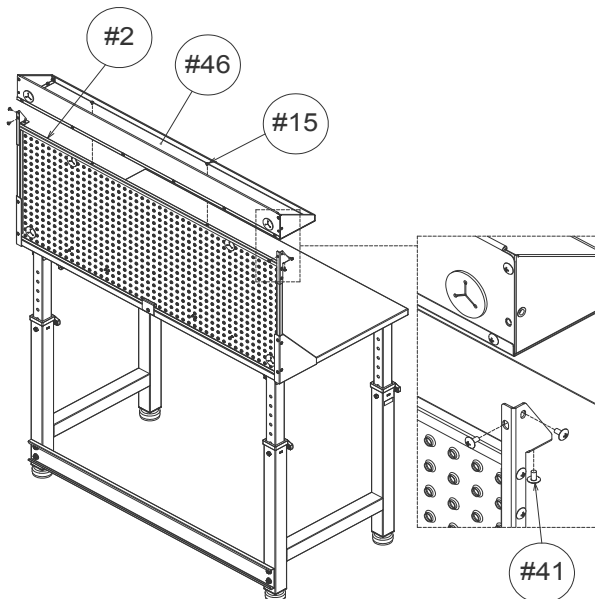

## Step 10. Install Drawer.

A. Attach (#20-3 & #20-4) Left & Right Drawer Side Panels and (#20-5) Drawer Back Panel to the (#19-2) Drawer Base Panel. Line up the screw holes and use 12pcs of (#15) Screw B to tighten.

**NOTE: Make sure the hook slots on the (#20-5) Drawer Back Panel are facing inward.**

**NOTE: Do not fully tighten the screws until next step.**

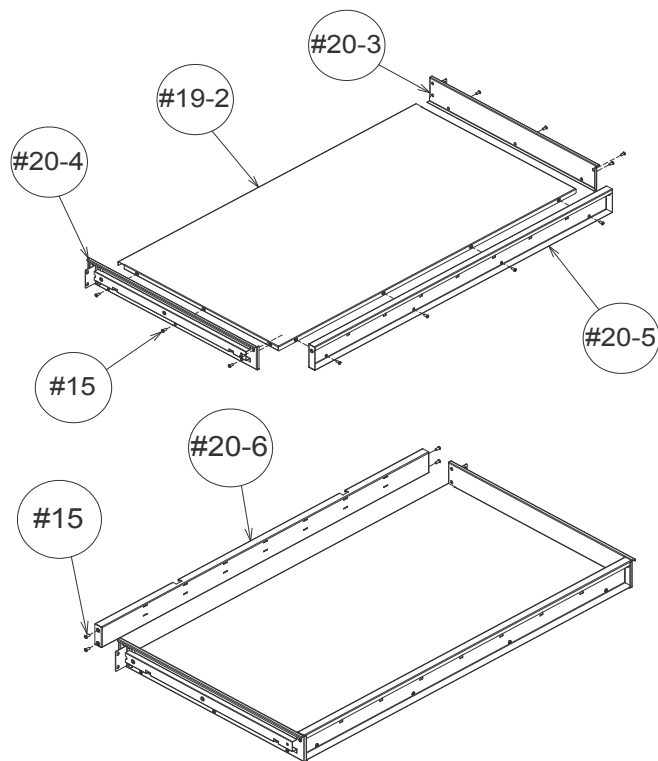

B. Attach (#20-6) Drawer Front Panel Support Plate as the left arrow shows. Line up the screw holes and use 4pcs of (#15) Screw B to tighten.

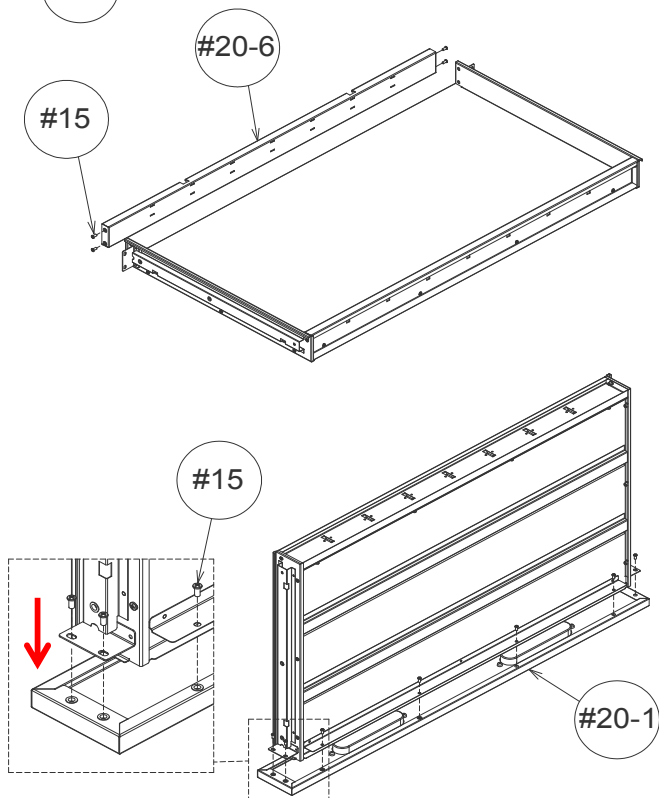

C. Attach the Drawer Case to the (#20-1) Drawer Front Panel. Line up the screw holes and use 8pcs of (#15) Screw B to tighten.

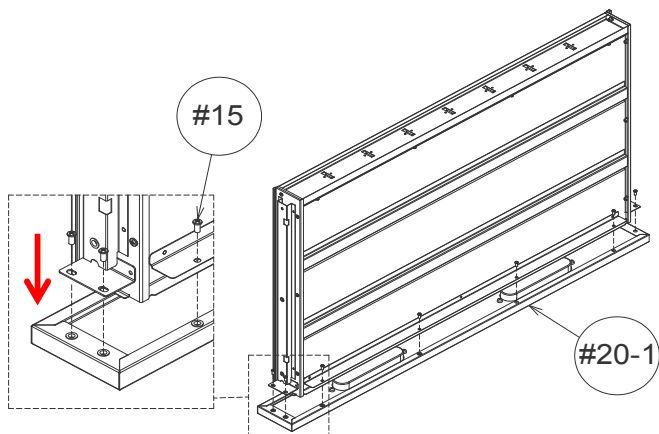

# UltraHD® LED Lighted Work Center (Model No. 20282)



**\*NOTE:** We recommend TWO people to assemble the workbench.



## Step 11: Insert Drawer.

**A.** Pull out the drawer sliders to full length.

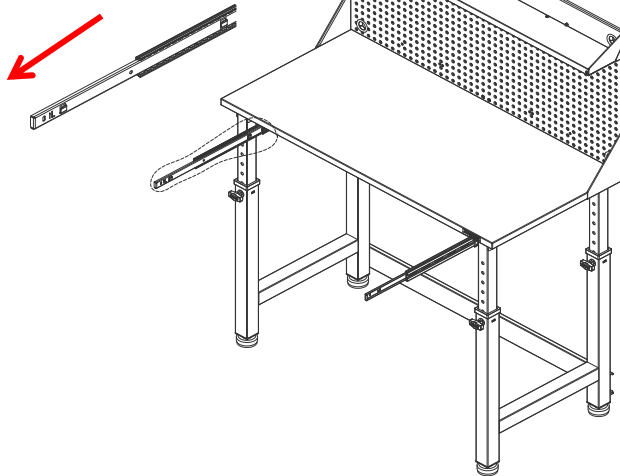

**B:** Attach and fit the Drawer to the inner track of the sliders and slide drawers in.

**NOTE:** Make sure to remove the rubber guards on the hooks of the inner track before fitting the drawer in.

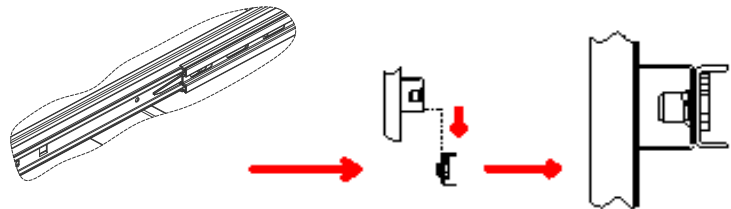
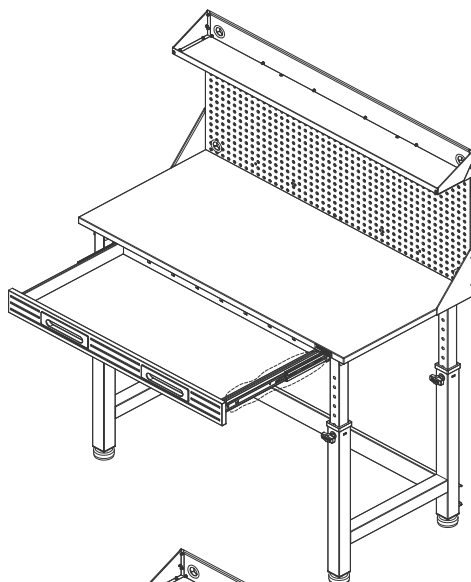

**C.** Once you insert the drawers, use 4pcs of (#15) Screw B to tighten drawer and slides.

**D.** After sliding in the Drawer, place (#18) Drawer Mats inside the drawer or you can place the (#18) Drawer Mat inside the drawer before you slide them in.

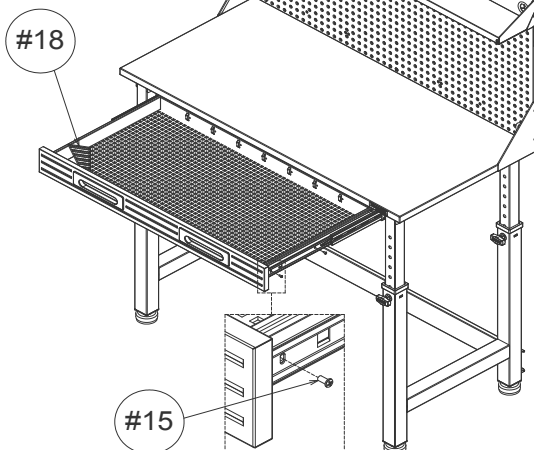

# UltraHD® LED Lighted Work Center (Model No. 20282)



\*NOTE: We recommend TWO people to assemble the workbench.



## Step 12. Install (#20-7) Drawer Divider.

A. Tilt and insert (#20-7) Drawer Divider into the drawer.

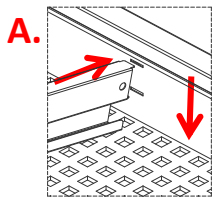

Back of  
Drawer  
Divider

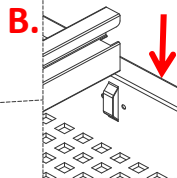
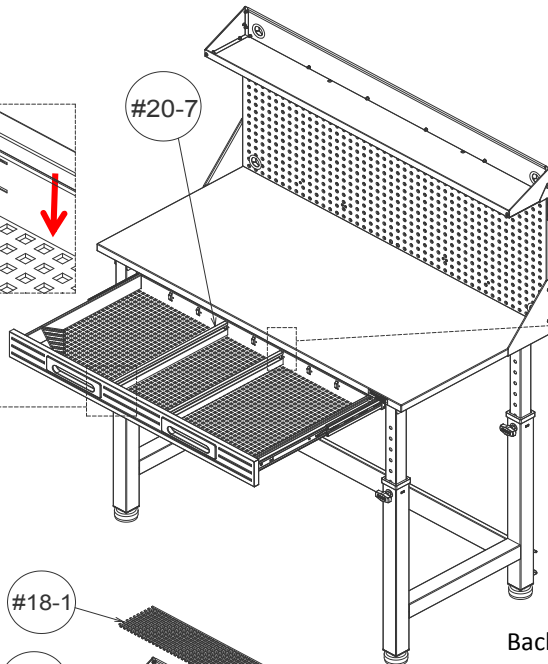

B: The solid wall of the divider should be facing the desired slot position. Slide the divider towards the slot, then push down into the slots.

Repeat the above steps to assemble another Drawer Divider.

### How to Remove the Drawer Divider:

Lift the Drawer Divider up and to the side to remove from the slot.

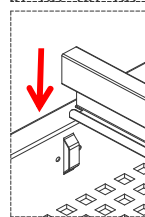

Back of Drawer  
Divider

## Step 13. Install (#44) LED Lamp.

A. Attach (#44) LED Lamp to the (#46) Top Cantilever Shelf, line up the screw holes, use 2pcs of (#15) Screw B to tighten.

Place the (#18-1) Top Cantilever Mat in place.

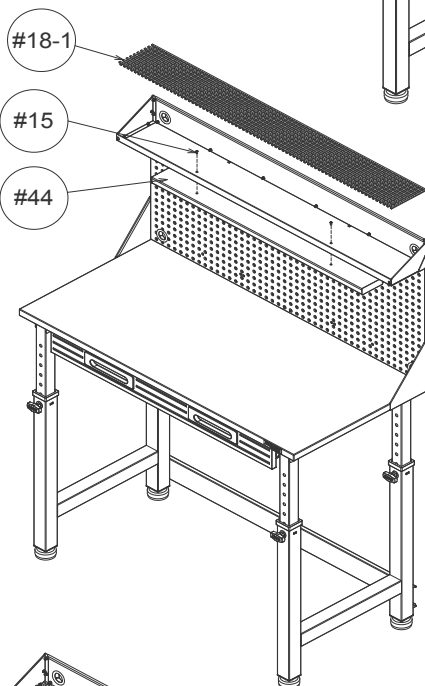

## Step 14. Place (#45) Power Strip

A. Insert and screw (#51) Stud Screw J to (#2) Pegboard Panel, then, hook (#45) Power Strip on and make sure the power cord goes through Rubber Grommet of (#2) Pegboard Panel.

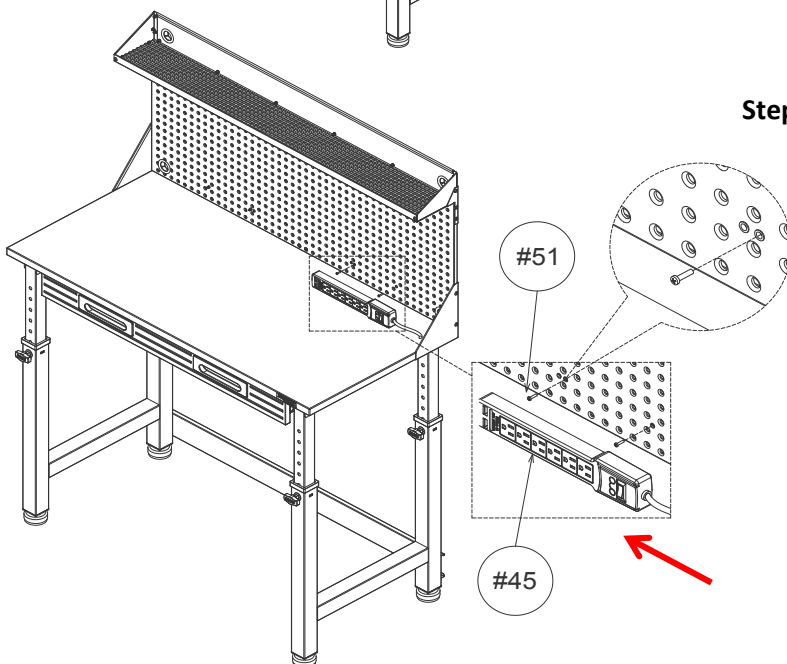

**NOTE:** You can position (#45) Power Strip on the left or right side of the (#2) Pegboard Panel.

## UltraHD® LED Lighted Work Center (Model No. 20282)



\*NOTE: We recommend TWO people to assemble the workbench.

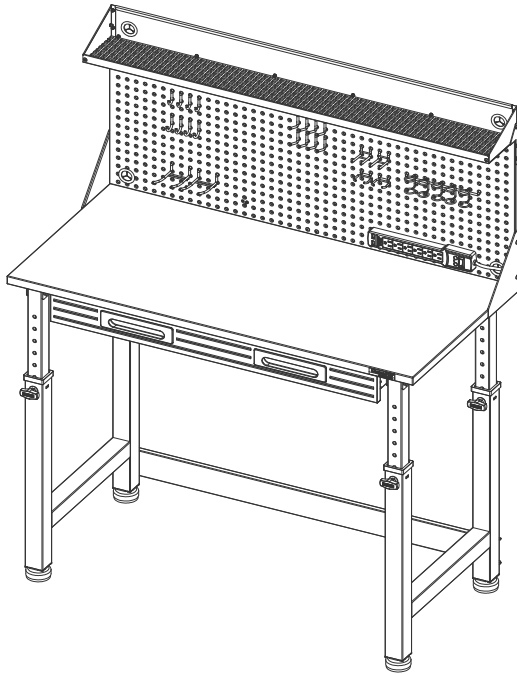

**Step 15. Place (#100), (#101), (#103), (#104), (#105), (#106), (#107) Hooks to Pegboard as you desire.**

### Install Pegboard to Wall

If the pegboard is installed on the wall, you do not need to install pegboard panel left support, pegboard panel right support, or pegboard panel middle support.

1). Select the position to install (#2) Pegboard, mark the locations for 4 holes as shown in following figure. After marking the locations, if installing on a solid wood wall, use 0.25 inch (6.35mm) drill holes; if installing on a cement wall or brick wall, use 0.375 inch (6.525mm) drill holes. Then, insert 4pcs of Plastic Anchors (#55-A) into the holes.

2). Attach the (#4) Spacers to the BACK of the pegboard, line up the holes, use 4pcs of (#55) Screw M with (#55-A) Plastic Anchors to tighten. See following figure.

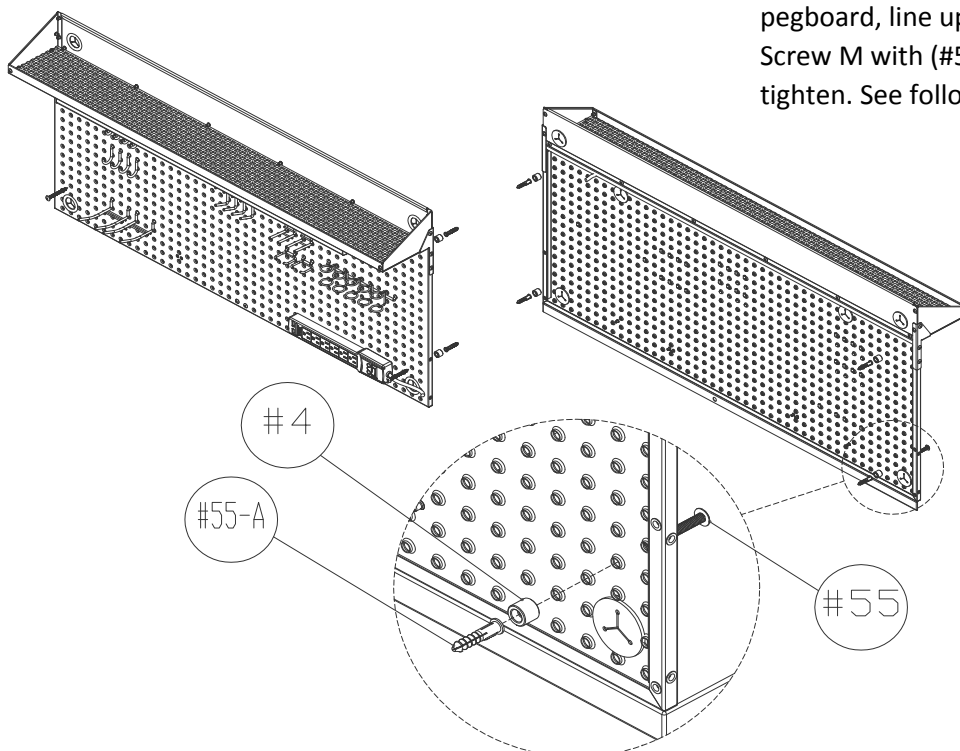



## UltraHD® LED Lighted Work Center (Model No. 20282)



\*NOTE: We recommend TWO people to assemble the workbench.



### CAUTION

RISK OF ELECTRIC SHOCK



Do not plug into another relocatable power tap

[!] **CAUTION:** Potential Shock or Fire Hazard. This unit is not intended for use in wet or potentially wet locations, such as showers, saunas, under or near fishtanks, sinks, etc.

### UltraHD® Stainless Steel Care Instructions

The stainless-steel parts of this product are protected with an UltraGuard® fingerprint resistant finish.

**DO NOT** use traditional stainless-steel cleaners. To safely manage unwanted fingerprints and prevent new stains, perform the following steps once monthly:

- Lightly wipe with warm water and clean microfiber cloth
- Always wipe in the direction of the surface grain (NEVER ACROSS)
- Wipe away excess water with dry clean cloth

### UltraHD® Wood Top Care Instructions

Our tops are made with real wood, and while great care is taken to ensure consistent top color and graining, there may be natural variations between finished products. We hand select the wood for every top to ensure the material is undamaged and naturally beautiful. If the wood top is received with excessive damage or splitting, Seville Classics will guarantee replacement of the top. Variations of color, and minor scratches in the clear coat finish will not be reason for replacement.

### Restore Shallow Scratches or Chips

The wood surface of this product is finished with a polyurethane coat. If the wood top becomes chipped or scratched, a polyurethane coat can be reapplied to restore a smooth texture and protect from future damage.

- Please follow the manufacturer's instruction on the product for application.

## UltraHD® LED Lighted Work Center (Model No. 20282)



**\*NOTE: We recommend TWO people to assemble the workbench.**



ATTENTION: Changes or modifications not expressly approved by the party responsible for compliance could void the user's authority to operate this device;

NOTE: This equipment has been tested and found to comply with the limits for a Class B digital device, pursuant to part 15 of the FCC Rules. These limits are designed to provide reasonable protection against harmful interference in a residential installation. This equipment generates, uses, and can radiate radio frequency energy and, if not installed and used in accordance with the instructions, may cause harmful interference to radio communications. However, there is no guarantee that interference will not occur in a particular installation. If this equipment does cause harmful interference to radio or television reception, which can be determined by turning the equipment off and on, the user is encouraged to try to correct the interference by one or more of the following measures:

- Reorient or relocate the receiving antenna.
- Increase the separation between the equipment and receiver.
- Connect the equipment into an outlet on a circuit different from that to which the receiver is connected.
- Consult the dealer or an experienced radio/TV technician for help.

This device complies with Part 15 of the FCC Rules. Operation is subject to the following two conditions:

(1) This device may not cause harmful interference, and

(2) this device must accept any interference received, including interference that may cause undesired operation.



## CONTACT INFORMATION

If you are missing any parts, have any questions, or need additional assistance in assembly, please contact our bilingual (English and Spanish) customer service department at:



Seville Classics, Inc.

19401 Harborage Way Torrance, CA 90501 USA

Telephone: (800) 323-5565 within USA

Fax: (310) 533-3899

Hours: 8:30am - 4:30pm (Pacific Standard Time)

E-mail: [support@sevilleclassics.com](mailto:support@sevilleclassics.com)

Website & Online Store: [www.sevilleclassics.com](http://www.sevilleclassics.com)

**\*\*\*Please visit our website or call and inquire about our additional UltraHD® Line\*\*\***

## UltraHD® Line

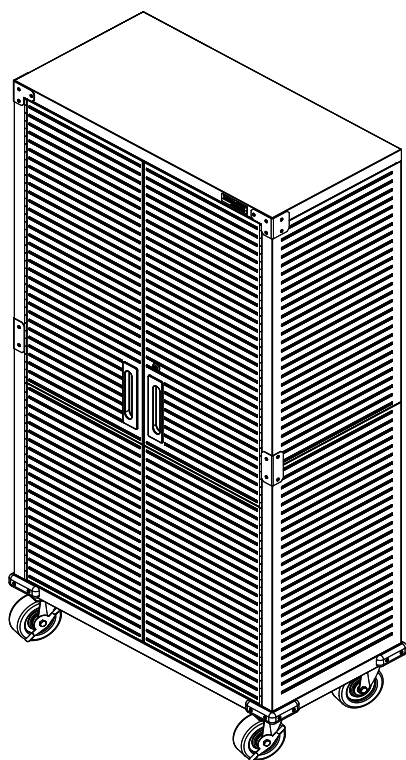

### **UltraHD® Tall Storage Cabinet**

**Model No. 16236 (Granite)**

**Model No. 20143 (Graphite)**

**Model No. 20153 (Red)**

**Model No. 20133 (White)**

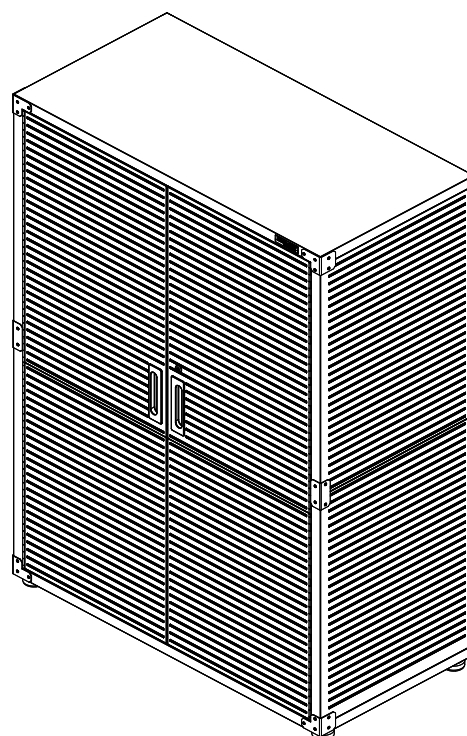

### **UltraHD® Mega Storage Cabinet**

**Model No. 16238 (Granite)**

**Model No. 20148 (Graphite)**

**Model No. 20158 (Red)**

**Model No. 20138 (White)**

# UltraHD® Line

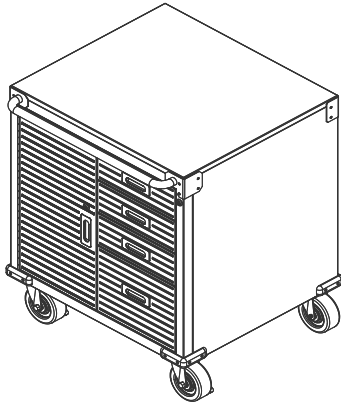

**UltraHD® Rolling Cabinet**  
Model No. 20225 (Granite)  
Model No. 20081 (Graphite)  
Model No. 20082 (Red)  
Model No. 20083 (White)

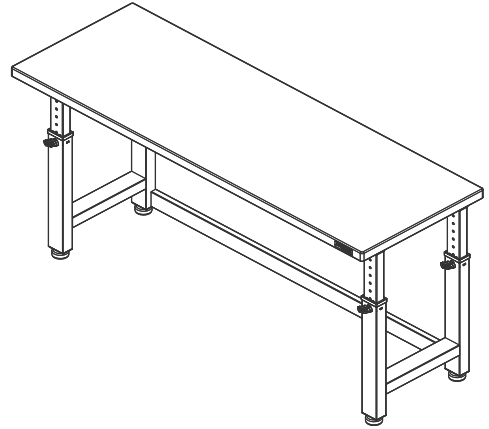

**UltraHD® 6-Foot Height Adjustable Workbench**  
Model No. 20292 (Granite)  
Model No. 20293 (Graphite)  
Model No. 20134 (Red)  
Model No. 20131 (White)

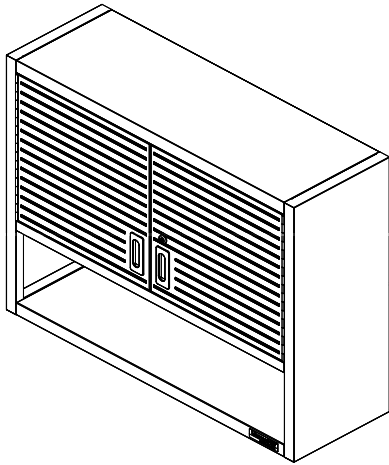

**UltraHD® Wall Cabinet with Open Shelf**  
Model No. 20230 (Granite)  
Model No. 20140 (Graphite)  
Model No. 20150 (Red)  
Model No. 20130 (White)

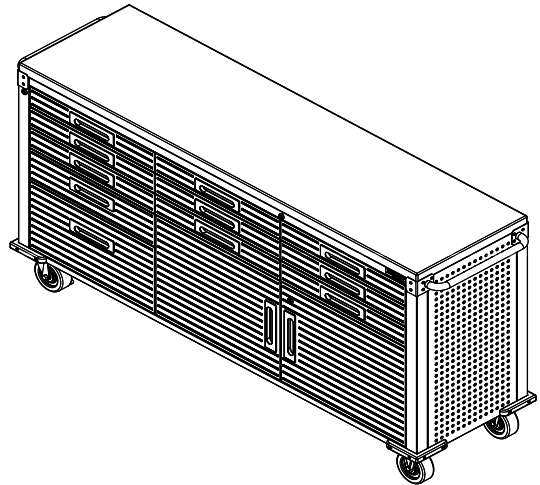

**UltraHD® 2-Door Rolling Workbench**  
Model No. 20262 (Granite)  
Model No. 20142 (Graphite)  
Model No. 20152 (Red)  
Model No. 20132 (White)

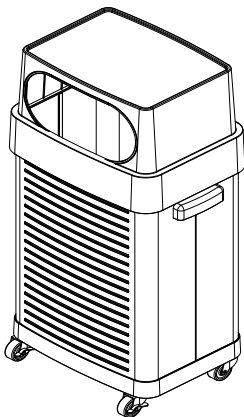

**UltraHD® Rolling Trash Bin**  
Model No. 20215

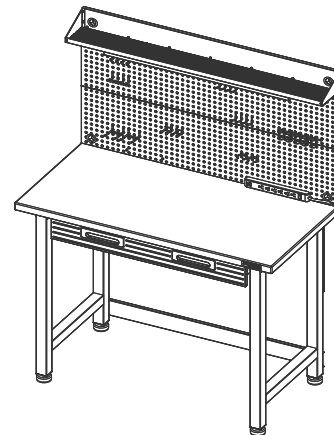

**UltraHD® Lighted Workcenter**  
Model No. 20247 (Granite)  
Model No. 20246 (Graphite)  
Model No. 20157 (Red)  
Model No. 20291 (White)