

TRUCK RACK Installation Guide

Please read all installation guide before using this product.



✉ jcwinauto@gmail.com
ebay@syneticusa.com



SYNETICUSA®

🌐 <https://jcwinauto.com/>
<http://syneticusa.com/>

☎ 626-360-5034
Mon-Fri 9am-5pm (PT)



COMPONENTS

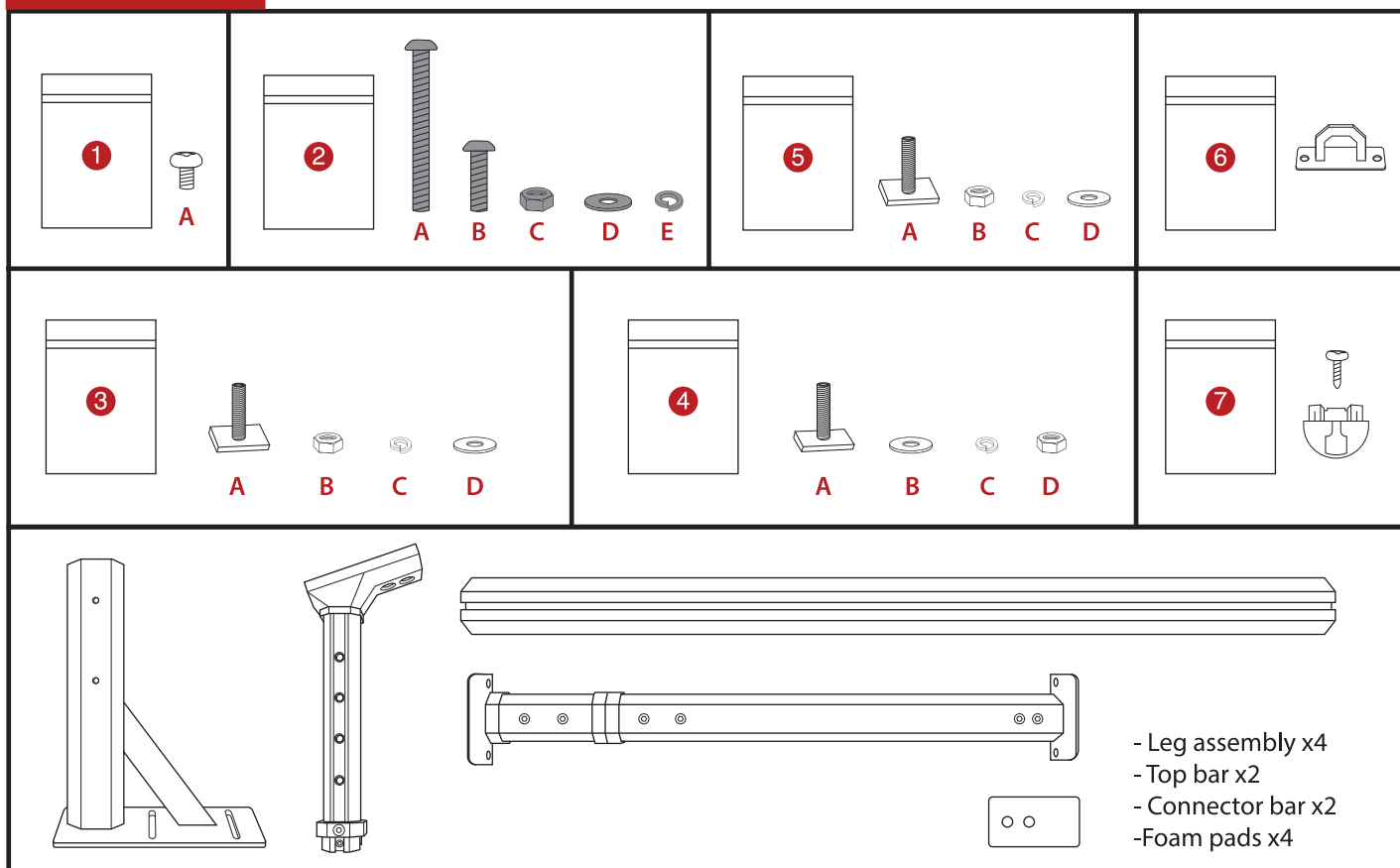

1 LOADING SCREW

Remove the front cover panel and *withdraw the rubber seal from the rail. From the front end of the rail, slide four t-bolts into the groove of the rail, do this for the other rail. Apply the hardware from pack 4 to the four base parts of the leg as shown in the drawing on the right.

***ONLY IF you have used the rubber seal previously**

Number	Part name	Size (mm)	In pack #
1	T-bolt 4A	Screw: M8*25 Nut: M8 (20*15*T5)	4
2	Spring washer 4C	M8	4
3	Flat washer 4B	M8	4
4	Nut (black) 4D	M8	4

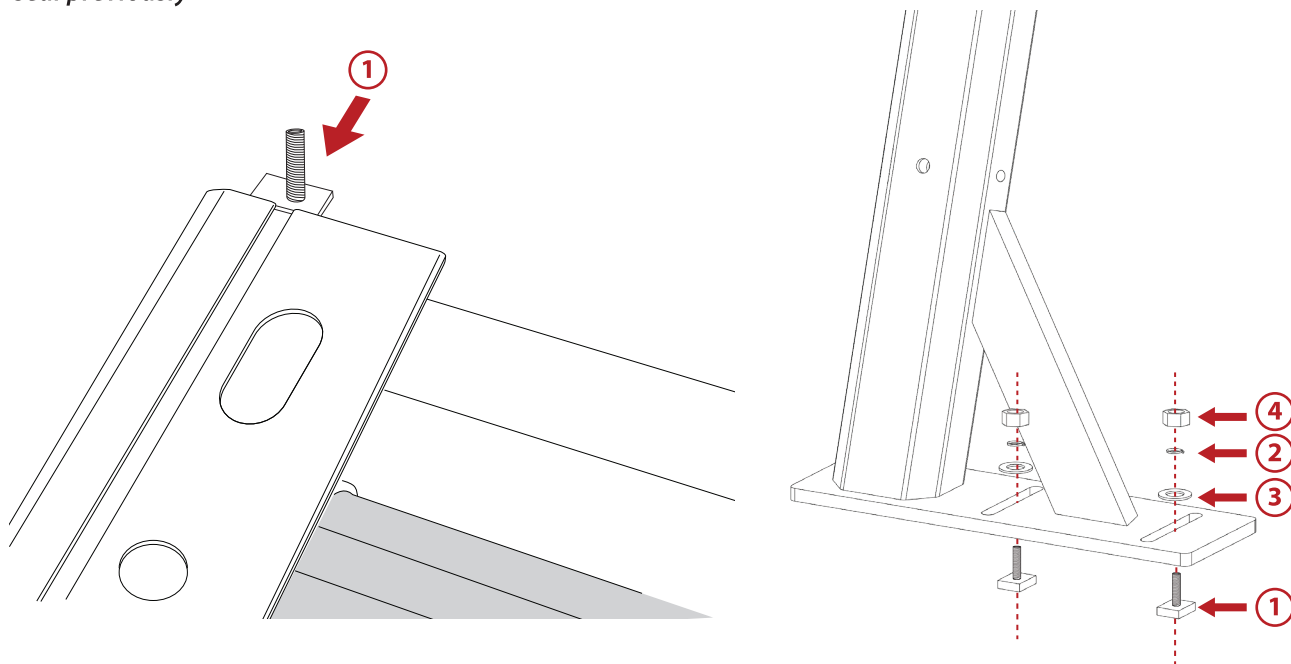

2 INSTALL THE RING PLATE

Number	Part name	Size (mm)	In pack #
1	T-bolt 5A	Screw: M8*30 Nut: M8 (20*15*T5)	5
2	Ring plate	92*54	6
3	Flat washer 5D	M8	5
4	Spring washer 5C	M8	5
5	Nut (black) 5B	M8	5

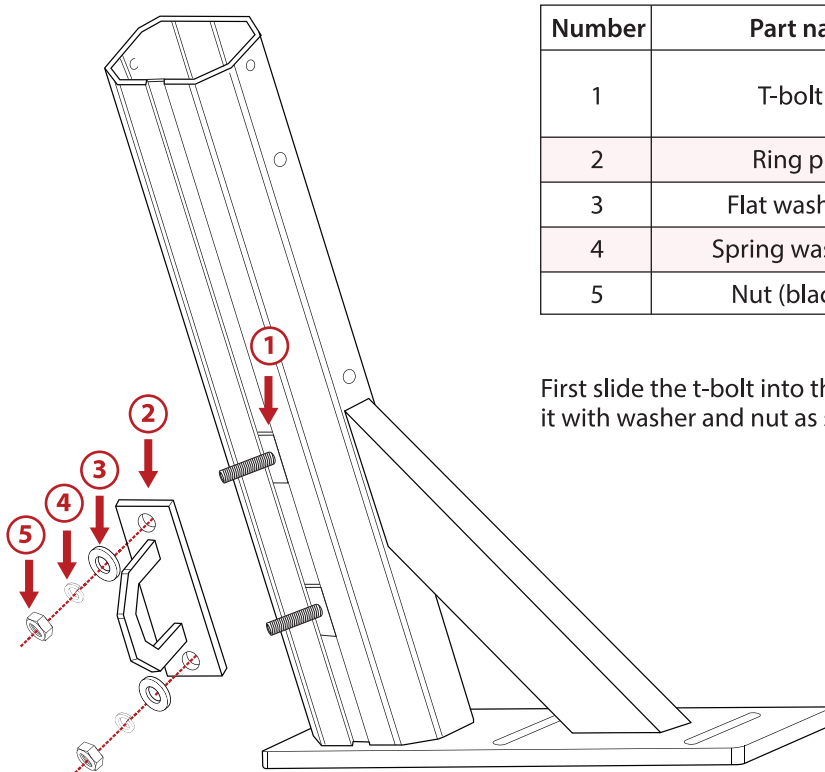

First slide the t-bolt into the groove of the leg, then lock the ring plate to it with washer and nut as shown.

3

INSTALL BASE: 4 TOTAL

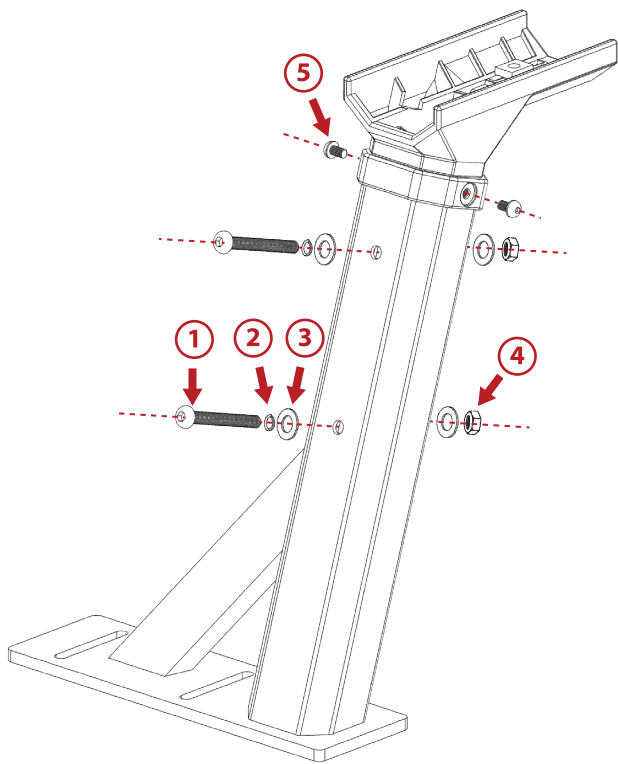

Number	Part name	Size (mm)	In pack #
1	Round hexa screw (black) 2A	M8*70	2
2	Spring washer (black) 2E	M8	2
3	Flat washer (black) 2D	M8	2
4	Nut (black) 2C	M8	2
5	Round philips screw 1A	M6*8	1

Pictures will show you different angles of how this step looks like. After connecting the 2 leg pieces, lock in with 2 philips screws as shown numbered 5.

Adjust the height of the legs to the desired length, it is important to make sure all four legs are at equal height when doing this.

Use the longer round hexa screw, flat washer and spring washer from pack 2 on the holes from the outside, then lock the other side with nut and flat washer also from pack 2, you will do this twice as shown.

Apply the sticky foam pad to the top of each of the four legs. The holes on the pad should match exactly with the holes on the leg when applied properly.

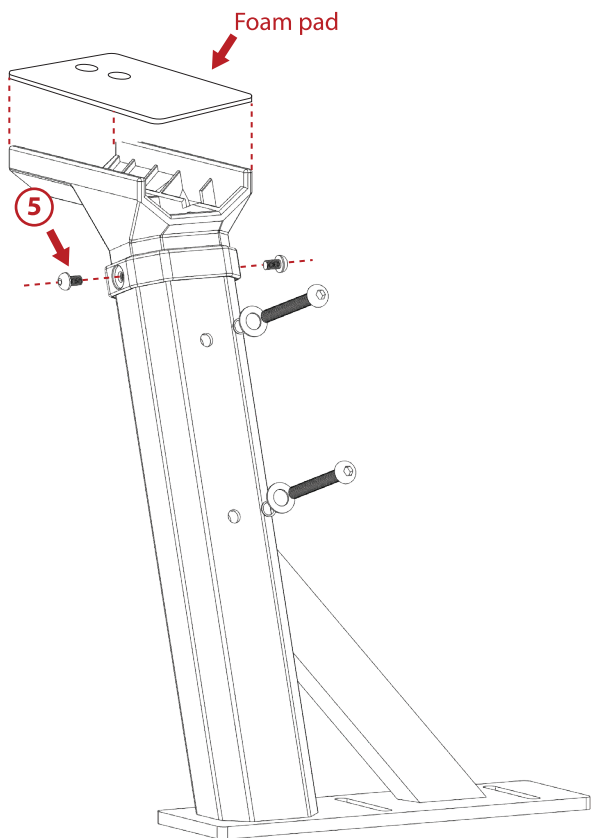
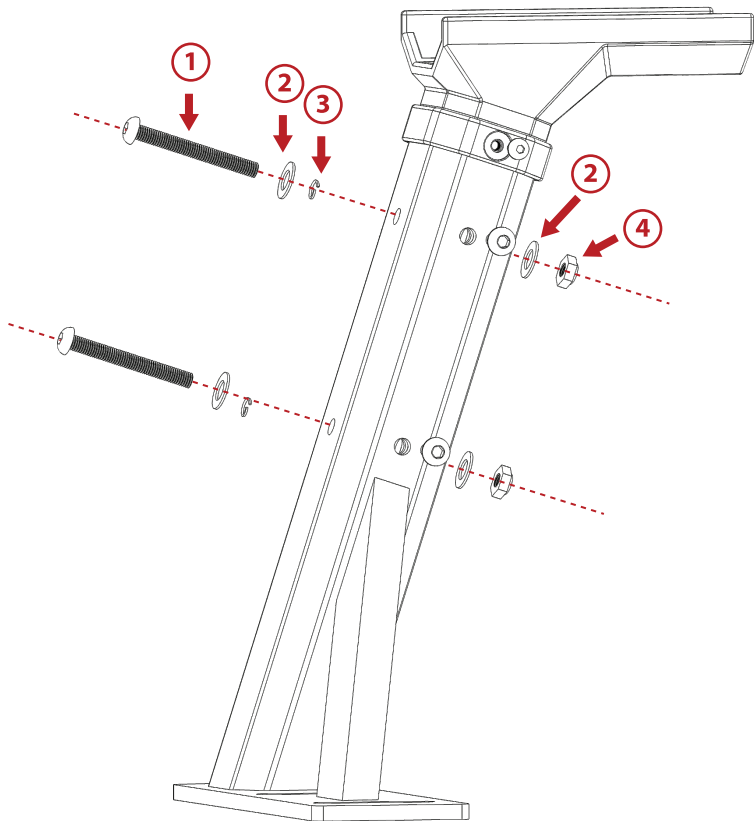

4

SIDEBAR-BASE CONNECTION

Loose the 2 screws on the outside of the bar (see drawing) and adjust both bars to the desired length, it is important to keep both bars at equal length when doing this, then tighten the screws.

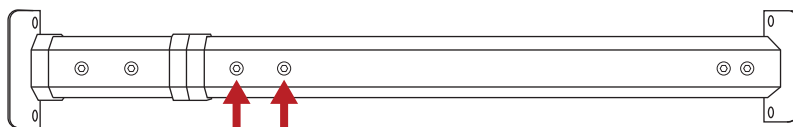

Using the screws from pack 2, lock in the sidebar to the part assembled in the previous step. Pictures will show 2 angles of how this is done.

Number	Part name	Size (mm)	In pack #
1	Round hexa screw (black) 2B	M8*12	2

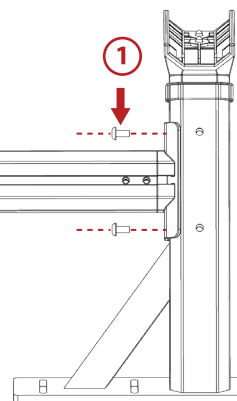
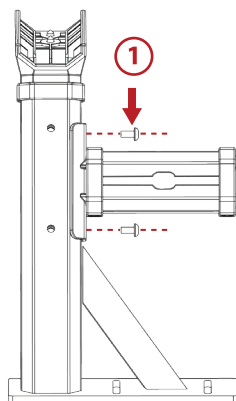
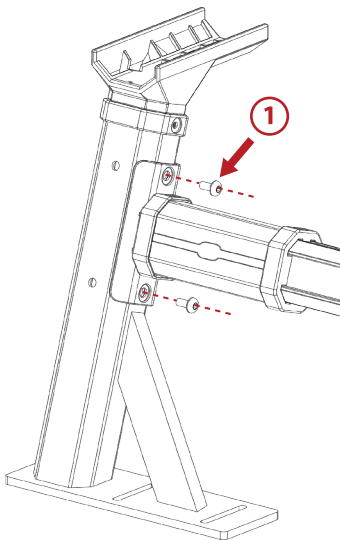

5

INSTALL TOP BAR

First, slide the t-bolt in pack 3 into the groove of the bar.

Using screws in pack 7, attach and lock in the end caps.

Flip the bar upside-down and match the screw to the hole on the previously assembled part, lock in the flat washer, spring washer, and nut from the bottom up.

Number	Part name	Size (mm)	In pack #
1	T-bolt 3A	Screw: M8*30 Nut: M8 (20*15*T5)	3
2	Round Philips screw	M4*16	7
3	Flat washer 3D	M8	3
4	Spring washer 3C	M8	3
5	Nut (black) 3B	M8	3

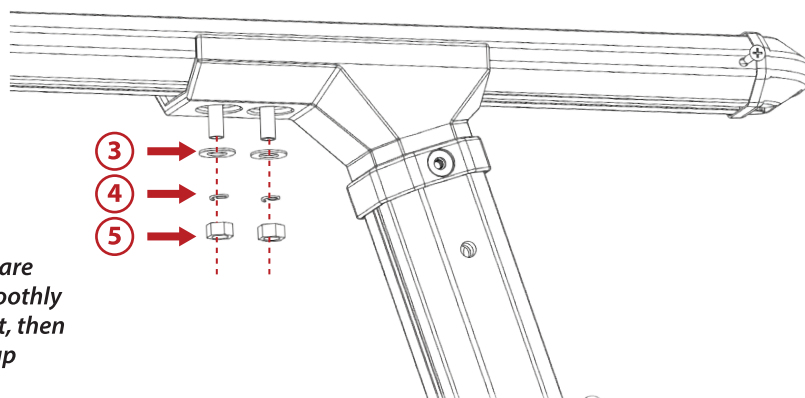
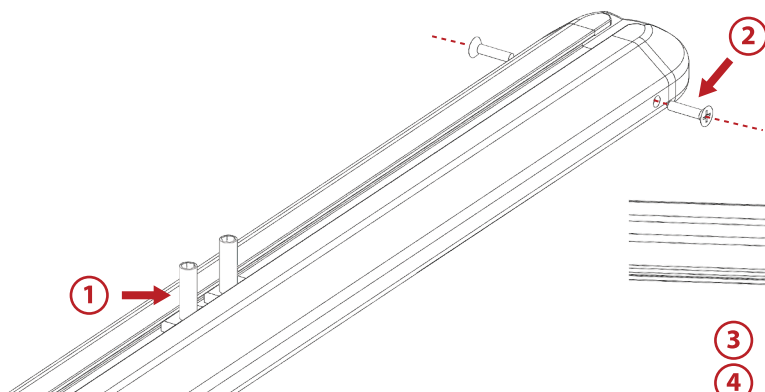

Note: Do NOT tighten anything until all the bars and bases are set in the right spots, also check that the cover can slide smoothly back and forth. If sliding is still tight, tighten everything first, then the cover will break in and adjust on its own to the new setup after a week or so.