

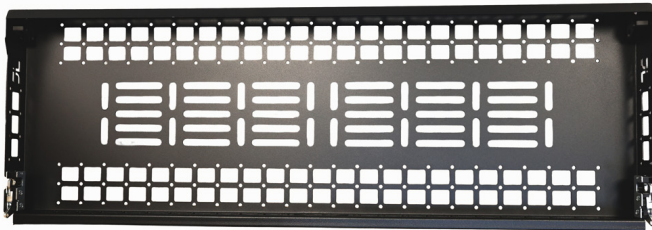

JL-RCST REAR ATTIC SHELF (JL) 2018+

INSTRUCTIONS

In-the-Box:



(1) Flip-Down Attic Shelf

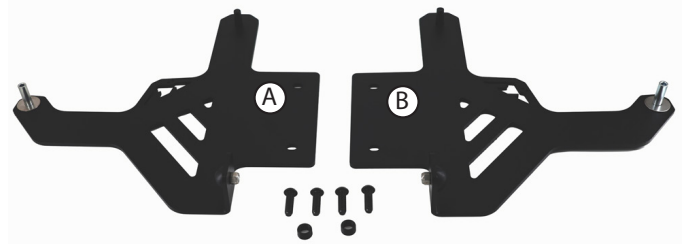

(2) Left and Right mounting Brackets

(3) 4 - M8 Bolts and 2 - Spacers

Tools Needed:



1



Step 1: Access and Locate Bolt Holes on the Roll Bar

Remove the plastic panel on the underside of the roll bar to expose the threaded bolt holes.

Note: Some factory bolts may already be installed in these holes. If so, remove them before continuing.

Step 2: Install Driver Side Attic Shelf Bracket (A)

Position Attic Shelf Bracket (A) over the bolt holes located in Step 1. Secure using the supplied M8 bolts. Use an M4 hex key for installation.

Important: Do not fully tighten the bolts at this stage—leave them slightly loose to allow for adjustment.



2



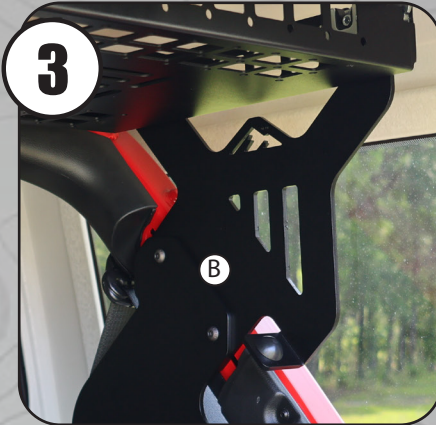

Step 3: Install Passenger Side Attic Shelf Bracket (B)

Repeat Steps 1 and 2 for the Driver Side Bracket to install the Passenger Side Attic Tray Bracket.

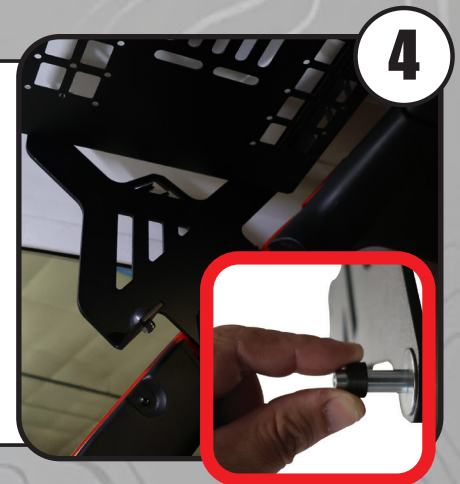

Step 4: Install the Driver Side of the Attic Shelf

Carefully place the tray into the back of the vehicle, aligning the hinge of the tray with the pin on the driver side Attic Shelf Bracket. Be sure to place the spacer onto the pin before inserting the tray—this step is essential for proper fit and function. Support the passenger side of the tray during installation, and ask a friend to assist you to ensure stability and ease of alignment.



Step 5: Secure the Passenger Side of the Attic Shelf

While your friend continues to support the tray, place the spacer onto the pin on Bracket B. Once the spacer is in place, carefully align the Bracket B pin with the passenger side hinge of the tray.

After both sides are properly aligned, tighten all M8 bolts on the underside of the roll bar to eliminate any movement.

Important: Check that the tray latches properly. If the latch feels tight or doesn't engage smoothly, loosen the brackets and make minor adjustments. When correctly installed, the tray should latch easily and securely.



JL-RCST REAR ATTIC SHELF (JL) 2018+

I N S T R U C T I O N S

6



Step 5: Sit Back and look at your New Cargo Tray.

